



NORTHCOOLING

ÜRÜN KATALOĐU / *PRODUCT CATALOGS*

www.northcooling.com.tr



DÜZ PANO KUTUSU 1 GÖZLÜ / FLAT DIGITAL CONTROLE UNITS

KODU / CODE	RENK / COLOR	MALZEME / MATERIAL	TİP / TYPE	AĞIRLIK / WEIGHT/GR	AD / PCS
ES-200-1S	SİYAH / BLACK	ABS	TEK BUTON / SINGLE BUTTON	34.5	50
ES-200-1G	GİRİ / GRAY	ABS	TEK BUTON / SINGLE BUTTON	34.5	50
ES-200-1A	ANTRASİT / ANTHRACITE	ABS	TEK BUTON / SINGLE BUTTON	34.5	50



DÜZ PANO KUTUSU 2 GÖZLÜ / FLAT DIGITAL CONTROLE UNITS

KODU / CODE	RENK / COLOR	MALZEME / MATERIAL	TİP / TYPE	AĞIRLIK / WEIGHT/GR	AD / PCS
ES-200-2S	SİYAH / BLACK	ABS	ÇİFT BUTON / DOUBLE BUTTONS	42	50
ES-200-2G	GİRİ / GRAY	ABS	ÇİFT BUTON / DOUBLE BUTTONS	42	50
ES-200-2A	ANTRASİT / ANTHRACITE	ABS	ÇİFT BUTON / DOUBLE BUTTONS	42	50



DÜZ PANO KUTUSU 3 GÖZLÜ / FLAT DIGITAL CONTROLE UNITS

KODU / CODE	RENK / COLOR	MALZEME / MATERIAL	TİP / TYPE	AĞIRLIK / WEIGHT/GR	AD / PCS
ES-200-3S	SİYAH / BLACK	ABS	ÜÇ BUTON / TRIPLE BUTTONS	49.5	50
ES-200-3G	GİRİ / GRAY	ABS	ÜÇ BUTON / TRIPLE BUTTONS	49.5	50
ES-200-3A	ANTRASİT / ANTHRACITE	ABS	ÜÇ BUTON / TRIPLE BUTTONS	49.5	50

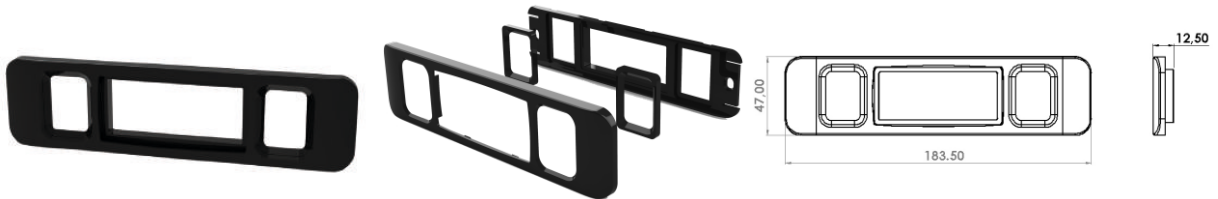

DÜZ KONTROL PANELİ / FLAT PANEL BOX

KODU / CODE	RENK / COLOR	MALZEME / MATERIAL	TİP / TYPE	AĞIRLIK / WEIGHT/GR	AD / PCS
ES-201-2S	SİYAH / BLACK	ABS	ÇİFT BUTON / DOUBLE BUTTONS	25.5	50
ES-201-2G	GİRİ / GRAY	ABS	ÇİFT BUTON / DOUBLE BUTTONS	25.5	50
ES-201-2A	ANTRASİT / ANTHRACITE	ABS	ÇİFT BUTON / DOUBLE BUTTONS	25.5	50



İNCE DÜZ PANO KUTUSU / THIN BOARD BOX CONTROLE UNITS

KODU / CODE	RENK / COLOR	MALZEME / MATERIAL	TİP / TYPE	AĞIRLIK / WEIGHT/GR	AD / PCS
ES-217-S	SİYAH / BLACK	ABS	TEK DİJİTAL / SINGLE DIGITAL	18	50
ES-217-G	GRİ / GRAY	ABS	TEK DİJİTAL / SINGLE DIGITAL	18	50
ES-217-A	ANTRASİT / ANTHRACITE	ABS	TEK DİJİTAL / SINGLE DIGITAL	18	50



İNCE DÜZ PANO KUTUSU TEK BUTON / THIN BOARD BOX SINGLE BUTTON

KODU / CODE	RENK / COLOR	MALZEME / MATERIAL	TİP / TYPE	AĞIRLIK / WEIGHT/GR	AD / PCS
ES-217-01S	SİYAH / BLACK	ABS	TEK BUTON / SINGLE BUTTON	24.5	50
ES-217-01G	GRİ / GRAY	ABS	TEK BUTON / SINGLE BUTTON	24.5	50
ES-217-01A	ANTRASİT / ANTHRACITE	ABS	TEK BUTON / SINGLE BUTTON	24.5	50



İNCE DÜZ PANO KUTUSU 2 GÖZLÜ / THIN FLAT BOX DOUBLE BUTTON

KODU / CODE	RENK / COLOR	MALZEME / MATERIAL	TİP / TYPE	AĞIRLIK / WEIGHT/GR	AD / PCS
ES-217-02S	SİYAH / BLACK	ABS	ÇİFT BUTON / DOUBLE BUTTONS	30.5	50
ES-217-02G	GRİ / GRAY	ABS	ÇİFT BUTON / DOUBLE BUTTONS	30.5	50
ES-217-02A	ANTRASİT / ANTHRACITE	ABS	ÇİFT BUTON / DOUBLE BUTTONS	30.5	50

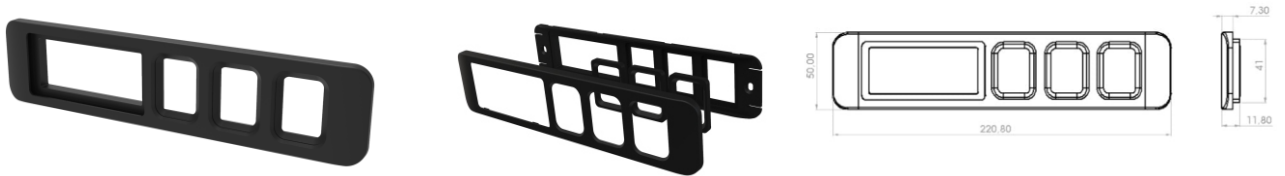

İNCE DÜZ PANO KUTUSU 3 GÖZLÜ / THIN FLAT BOX THREE BUTTONS

KODU / CODE	RENK / COLOR	MALZEME / MATERIAL	TİP / TYPE	AĞIRLIK / WEIGHT/GR	AD / PCS
ES-217-03S	SİYAH / BLACK	ABS	ÜÇ BUTON / TRIPLE BUTTONS	36	50
ES-217-03G	GRİ / GRAY	ABS	ÜÇ BUTON / TRIPLE BUTTONS	36	50
ES-217-03A	ANTRASİT / ANTHRACITE	ABS	ÜÇ BUTON / TRIPLE BUTTONS	36	50
ES-217-03GG	GÜMÜŞ GRİ / SILVER GRAY	ABS	ÜÇ BUTON / TRIPLE BUTTONS	36	50

ENDÜSTRİYEL MUTFAK GRUBU / THE GROUPS OF INDUSTRIAL KITCHEN

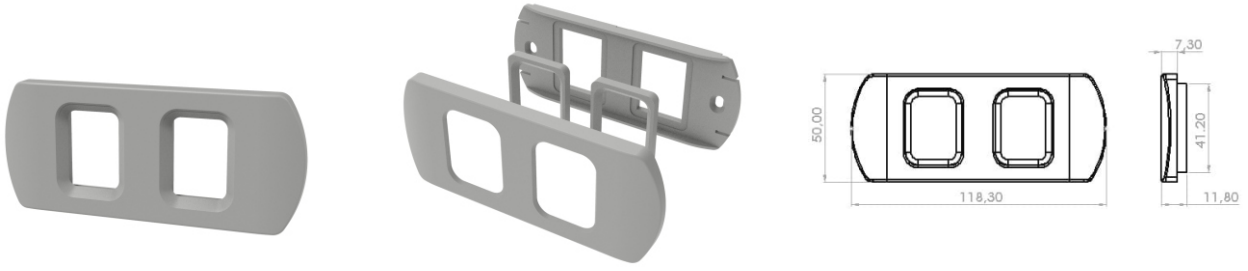

İNCE DÜZ PANO 2 ANAHTAR / THIN FLAT BOX 2 KEYS

KODU / CODE	RENK / COLOR	MALZEME / MATERIAL	TİP / TYPE	AĞIRLIK / WEIGHT/GR	AD / PCS
ES-257-02GG	GÜMÜŞ GRİ / SILVER GRAY	ABS	2 ANAHTAR / 2 KEYS	24	100

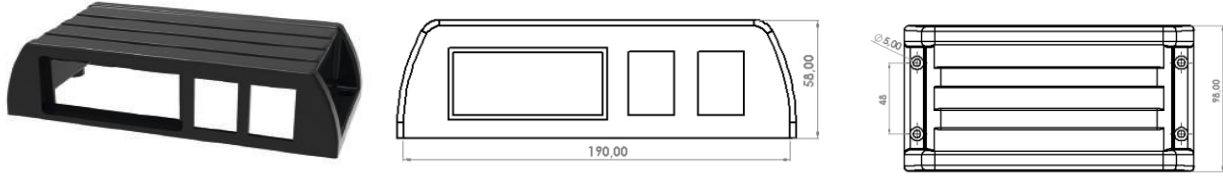

SÜTLÜK BOMBE PANO KUTUSU İKİ GÖZLÜ / DAIRY FRIDGE DIGITAL CONTROL UNIT

KODU / CODE	RENK / COLOR	MALZEME / MATERIAL	TİP / TYPE	AĞIRLIK / WEIGHT/GR	AD / PCS
ES-202-02S	SİYAH / BLACK	ABS	ÇİFT BUTON / DOUBLE BUTTONS	86	50
ES-202-02G	GRİ / GRAY	ABS	ÇİFT BUTON / DOUBLE BUTTONS	86	50
ES-202-02P	ANTRASİT / ANTHRACITE	ABS	ÇİFT BUTON / DOUBLE BUTTONS	86	50
ES-202-02B	BEYAZ / WHITE	ABS	ÇİFT BUTON / DOUBLE BUTTONS	86	50

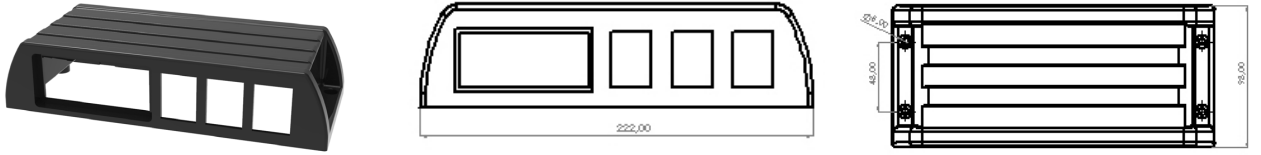

SÜTLÜK BOMBE PANO KUTUSU ÜÇ GÖZLÜ / DAIRY FRIDGE DIGITAL CONTROL UNIT

KODU / CODE	RENK / COLOR	MALZEME / MATERIAL	TİP / TYPE	AĞIRLIK / WEIGHT/GR	AD / PCS
ES-202-03S	SİYAH / BLACK	ABS	ÜÇ BUTON / TRIPLE BUTTONS	94	50
ES-202-03G	GRİ / GRAY	ABS	ÜÇ BUTON / TRIPLE BUTTONS	94	50
ES-202-03P	ANTRASİT / ANTHRACITE	ABS	ÜÇ BUTON / TRIPLE BUTTONS	94	50
ES-202-03B	BEYAZ / WHITE	ABS	ÜÇ BUTON / TRIPLE BUTTONS	94	50

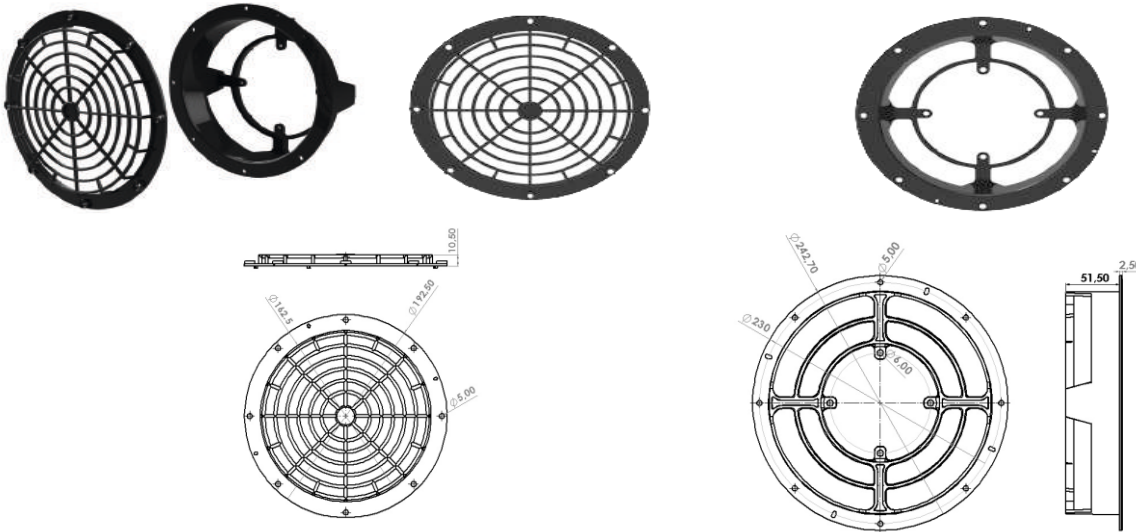

15 CM FAN ÇEMERİ / 15CM PLASTIC FAN GUARD

KODU / CODE	RENK / COLOR	MALZEME / MATERIAL	TİP / TYPE	AĞIRLIK / WEIGHT/GR	AD / PCS
ES-203-01	SİYAH / BLACK	ABS	ÖN KAPAK / FAN GUARD COVER	34,5	225
ES-203-02	SİYAH / BLACK	ABS	FAN ÇEMERİ GÖVDE / FAN GUARD BODY	64,5	75
ES-203	SİYAH / BLACK	ABS	FAN ÇEMERİ SET / FAN GUARD GROUP	99	225

ENDÜSTRİYEL MUTFAK GRUBU / THE GROUPS OF INDUSTRIAL KITCHEN

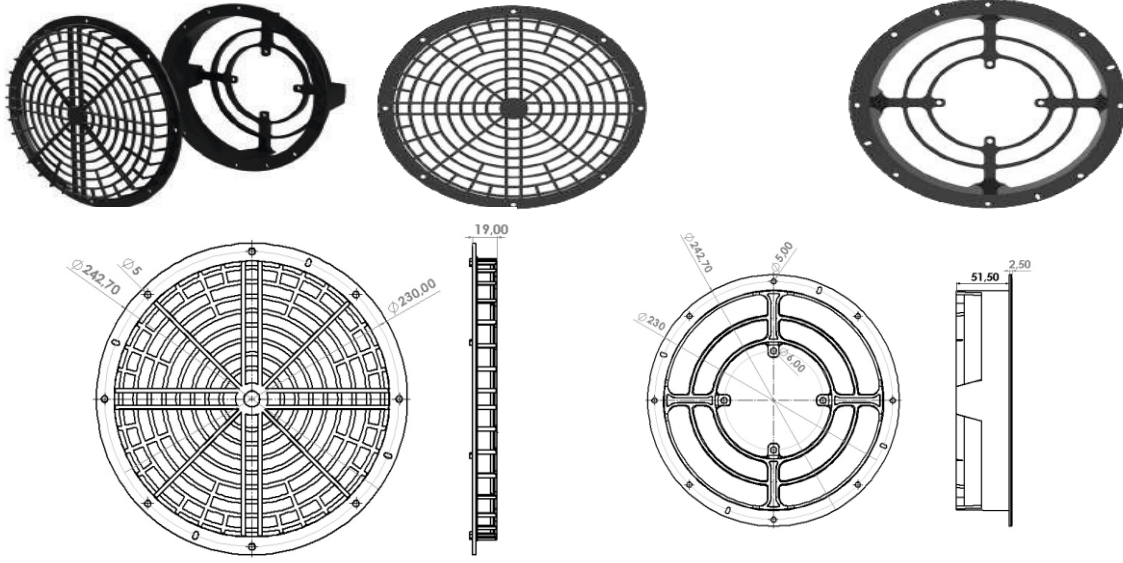

20 CM FAN ÇEMBERİ / 20 CM PLASTIC FAN GUARD

KODU / CODE	RENK / COLOR	MALZEME / MATERIAL	TİP / TYPE	AĞIRLIK / WEIGHT/GR	AD / PCS
ES-204-01	SİYAH / BLACK	ABS	ÖN KAPAK / FAN GUARD COVER	77	100
ES-204-02	SİYAH / BLACK	ABS	FAN ÇEMBERİ GÖVDE / FAN GUARD BODY	123	50
ES-204	SİYAH / BLACK	ABS	FAN ÇEMBERİ SET / FAN GUARD GROUP	200	100

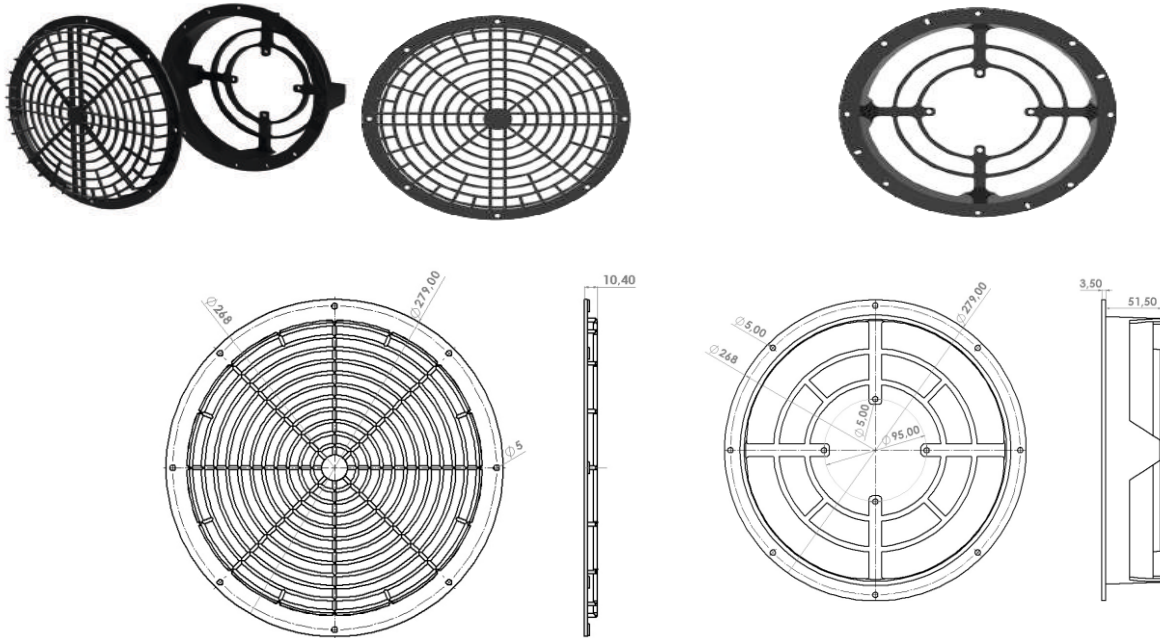

23 CM FAN ÇEMBERİ / 23 PLASTIC FAN GUARD

KODU / CODE	RENK / COLOR	MALZEME / MATERIAL	TİP / TYPE	AĞIRLIK / WEIGHT/GR	AD / PCS
ES-219-01	SİYAH / BLACK	ABS	ÖN KAPAK / FAN GUARD COVER	83	150
ES-219-02	SİYAH / BLACK	ABS	FAN ÇEMBERİ GÖVDE / FAN GUARD BODY	147.5	50
ES-219	SİYAH / BLACK	ABS	FAN ÇEMBERİ SET / FAN GUARD GROUP	230.5	150

ENDÜSTRİYEL MUTFAK GRUBU / THE GROUPS OF INDUSTRIAL KITCHEN

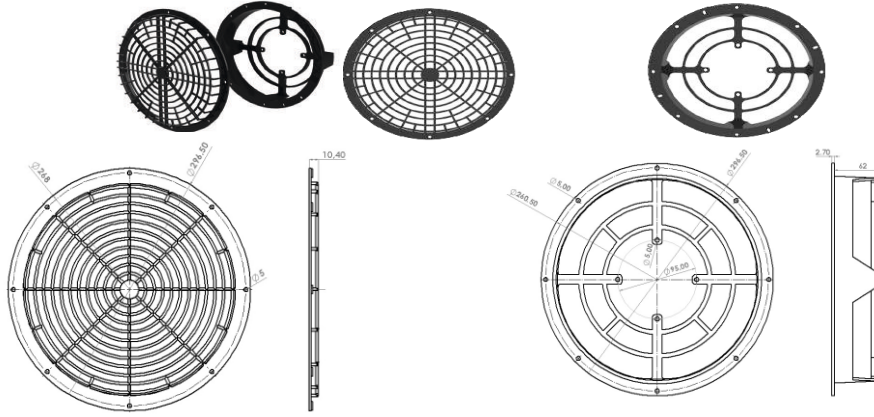

25 CM FAN ÇEMBERİ / 25 PLASTIC FAN GUARD

KODU / CODE	RENK / COLOR	MALZEME / MATERIAL	TİP / TYPE	AĞIRLIK / WEIGHT/GR	AD / PCS
ES-220-01	SİYAH / BLACK	ABS	ÖN KAPAK / FAN GUARD COVER	83	150
ES-220-02	SİYAH / BLACK	ABS	FAN ÇEMBERİ GÖVDE / FAN GUARD BODY	147.5	150
ES-220	SİYAH / BLACK	ABS	FAN ÇEMBERİ SET / FAN GUARD GROUP	230.5	50

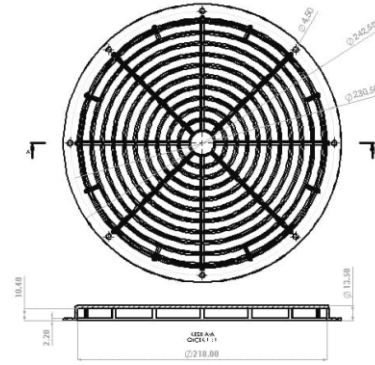
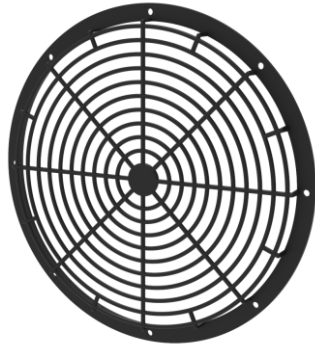

20 CM FAN KORUMA İNCE 13.50mm / 20 PLASTIC FAN GUARD 13.50mm

KODU / CODE	RENK / COLOR	MALZEME / MATERIAL	TİP / TYPE	AĞIRLIK / WEIGHT/GR	AD / PCS
ES-204-03	SİYAH / BLACK	ABS	FAN KORUMA / FAN GUARD	50	100

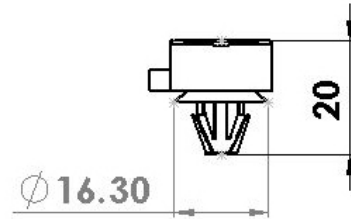
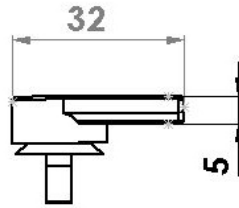

FAN KİLİTLEME FANI / FAN LOCKING FAN

KODU / CODE	RENK / COLOR	MALZEME / MATERIAL	TİP / TYPE	AĞIRLIK / WEIGHT/GR	AD / PCS
ES-240-01	SİYAH/BLACK	ABS	ABS	4	1000

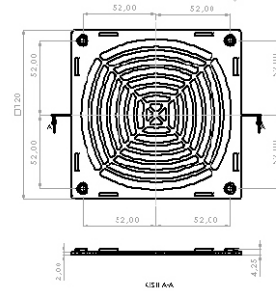
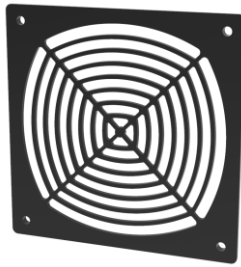

12X12 KARE FAN KORUMA / 12X12 SQUARE FAN GUARD

KODU / CODE	RENK / COLOR	MALZEME / MATERIAL	TİP / TYPE	AĞIRLIK / WEIGHT/GR	AD / PCS
ES-203-03	SİYAH/BLACK	ABS	12X12 CM	20	1000

ENDÜSTRİYEL MUTFAK GRUBU / THE GROUPS OF INDUSTRIAL KITCHEN



KARE FAN / SQUARE FAN

KODU / CODE	RENK / COLOR	MALZEME / MATERIAL	TİP / TYPE	AĞIRLIK / WEIGHT/GR	AD / PCS
ES-259-01	SİYAH / BLACK	ALÜMİNYUM	12X12X38 mm 220 V		1
ES-259-02	SİYAH / BLACK	ALÜMİNYUM	17X17X52 mm 220 V		1



ALÜMİNYUM PERVANE 28° EMİŞ / ALUMINUM PROPELLER 28° SUCTION

KODU / CODE	RENK / COLOR	MALZEME / MATERIAL	TİP / TYPE	AĞIRLIK / WEIGHT/GR	AD / PCS
ES-235-01	METALİK GRİ / METALLIC GRAY	ALÜMİNYUM / ALUMINUM	15 CM		50
ES-235-02	METALİK GRİ / METALLIC GRAY	ALÜMİNYUM / ALUMINUM	20 CM		50
ES-235-03	METALİK GRİ / METALLIC GRAY	ALÜMİNYUM / ALUMINUM	25 CM		50
ES-235-04	METALİK GRİ / METALLIC GRAY	ALÜMİNYUM / ALUMINUM	30 CM		50



PLASTİK PERVANE 28° EMİŞ / PLASTIC PROPELLER 28° SUCTION

KODU / CODE	RENK / COLOR	MALZEME / MATERIAL	TİP / TYPE	AĞIRLIK / WEIGHT/GR	AD / PCS
ES-235-01 P	GRİ / GRAY	PP	15 CM		500
ES-235-02 P	GRİ / GRAY	PP	20CM		500



Q FAN MOTORLAR / Q FAN MOTORS

KODU / CODE	RENK / COLOR	MALZEME / MATERIAL	TİP / TYPE	AĞIRLIK / WEIGHT/GR	AD / PCS
ES-260-01	METALİK/METALIC	ALÜMİNYUM/ALUMINUM	30 W		1
ES-260-02	METALİK/METALIC	ALÜMİNYUM/ALUMINUM	50 W		1
ES-260-03	METALİK/METALIC	ALÜMİNYUM/ALUMINUM	65 W		1
ES-260-04	METALİK/METALIC	ALÜMİNYUM/ALUMINUM	95 W		1

ENDÜSTRİYEL MUTFAK GRUBU / THE GROUPS OF INDUSTRIAL KITCHEN



FAN KORUMA ÇEMBERİ / FAN PROTECTION CIRCLE

KODU / CODE	RENK / COLOR	MALZEME / MATERIAL	TİP / TYPE	AĞIRLIK / WEIGHT/GR	AD / PCS
ES-236-01	SİYAH / BLACK	DEMİR / IRON	20 CM		
ES-236-02	SİYAH / BLACK	DEMİR / IRON	25 CM		
ES-236-03	SİYAH / BLACK	DEMİR / IRON	30 CM		

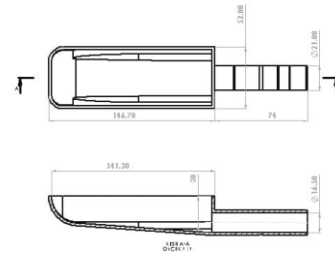
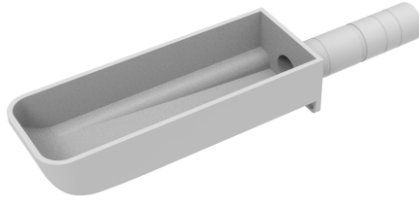

SULUK / LEECH

KODU / CODE	RENK / COLOR	MALZEME / MATERIAL	TİP / TYPE	AĞIRLIK / WEIGHT/GR	AD / PCS
ES-251-01	GRİ/GREY	ABS	STANDART	53	50

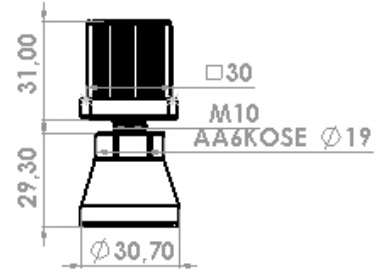

30X30 M10 PLASTİK ROTİL AYAK / 30X30 M10 PLASTICK BALL ROD FOOT

KODU / CODE	RENK / COLOR	MALZEME / MATERIAL	TİP / TYPE	AĞIRLIK / WEIGHT/GR	AD / PCS
ES-205-06 M1050	SİYAH / BLACK	ABS	M10X50 30X30 PROFILE	61.50	200

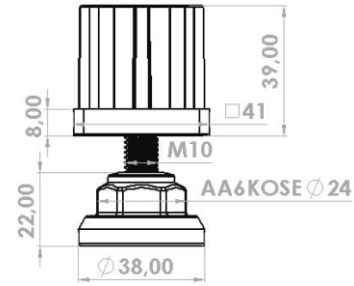

40X40 M10 PLASTİK ROTİL AYAK / 40X40 M10 PLASTICK BALL ROD FOOT

KODU / CODE	RENK / COLOR	MALZEME / MATERIAL	TİP / TYPE	AĞIRLIK / WEIGHT/GR	AD / PCS
ES-205-08 M1050	SİYAH / BLACK	PP (MOBLEN) ÇELİK VİDA / IRON ADJUSTING SCREW	M10X50 40X40 PROFILE	88.30	500

ENDÜSTRİYEL MUTFAK GRUBU / THE GROUPS OF INDUSTRIAL KITCHEN

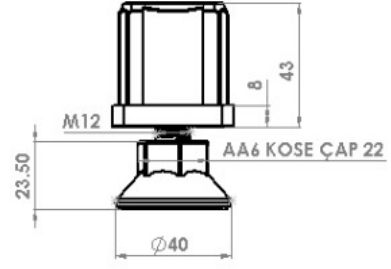

40X40 M12 PLASTİK ROTİL AYAK / 40X40 M12 PLASTICK BALL ROD FOOT

KODU / CODE	RENK / COLOR	MALZEME / MATERIAL	TİP / TYPE	AĞIRLIK / WEIGHT/GR	AD / PCS
ES-205-05M1250	SİYAH / BLACK	PP (MOBLEN) ÇELİK VİDA / IRON ADJUSTING SCREW	M12X50 40X40 PROFILE	92.60	200

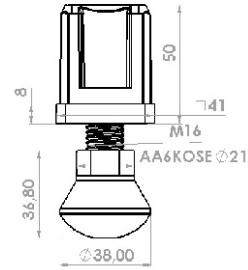

40X40 M16 PLASTİK BOMBE ROTİL AYAK / 40X40 M16 PLASTICK BALL ROD FOOT

KODU / CODE	RENK / COLOR	MALZEME / MATERIAL	TİP / TYPE	AĞIRLIK / WEIGHT/GR	AD / PCS
ES-205-01M1650	SİYAH / BLACK	PP (MOBLEN) DEMİR CİVATA / IRON ADJUSTING SCREW	M16X50 40X40 PROFILE	181.00	200
ES-205-01M1670	SİYAH / BLACK	PP (MOBLEN) DEMİR CİVATA / IRON ADJUSTING SCREW	M16X70 40X40 PROFILE	206.50	200
ES-205-01M16100	SİYAH / BLACK	PP (MOBLEN) DEMİR CİVATA / IRON ADJUSTING SCREW	M16X100 40X40 PROFILE	219.50	200
ES-205-01M16120	SİYAH / BLACK	PP (MOBLEN) DEMİR CİVATA / IRON ADJUSTING SCREW	M16X120 40X40 PROFILE	245.50	200

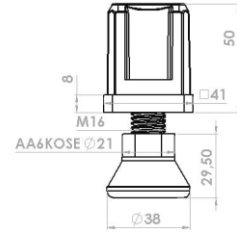

40X40 M16 PLASTİK DÜZ ROTİL AYAK 40X40 M16 FLAT BASED FEET GROUP

KODU / CODE	RENK / COLOR	MALZEME / MATERIAL	TİP / TYPE	AĞIRLIK / WEIGHT/GR	AD / PCS
ES-205-03M1650	SİYAH / BLACK	PP (MOBLEN) DEMİR CİVATA / IRON ADJUSTING SCREW	M16X50 40X40 PROFILE	176.00	200
ES-205-03M1670	SİYAH / BLACK	PP (MOBLEN) DEMİR CİVATA / IRON ADJUSTING SCREW	M16X70 40X40 PROFILE	203.00	200
ES-205-03M16100	SİYAH / BLACK	PP (MOBLEN) DEMİR CİVATA / IRON ADJUSTING SCREW	M16X100 40X40 PROFILE	216.00	200

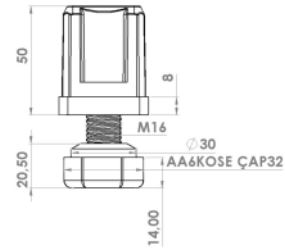

40X40 M16 ALTI KÖŞE ROTİL AYAK PLASTİK GÖVDE / M16 SIX BASED FEET GROUP

KODU / CODE	RENK / COLOR	MALZEME / MATERIAL	TİP / TYPE	AĞIRLIK / WEIGHT/GR	AD / PCS
ES-205-05M1660	SİYAH / BLACK	PP (MOBLEN) ÇELİK VİDA / IRON ADJUSTING SCREW	M16X60 40X40 PROFILE	186.50	200

ENDÜSTRİYEL MUTFAK GRUBU / THE GROUPS OF INDUSTRIAL KITCHEN

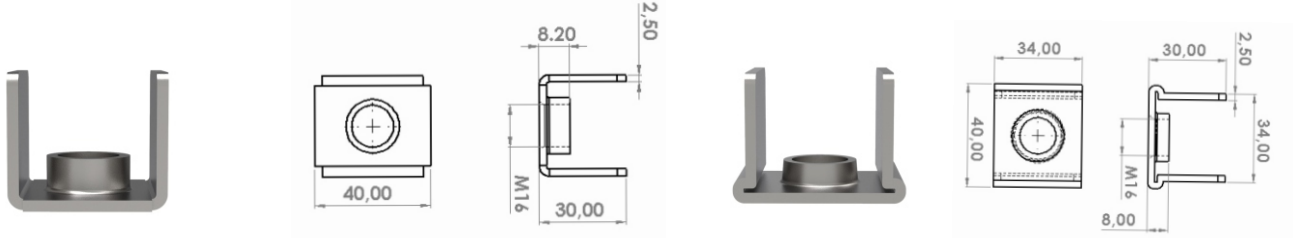

40x40 ROTİL AYAK SAC GÖVDE / METAL SHEET FEETS

KODU / CODE	RENK / COLOR	MALZEME / MATERIAL	TİP / TYPE	AĞIRLIK / WEIGHT/GR	AD / PCS
ES-206-01	METALİK / METALIC COLOR	SAC METAL / SHEET METAL	FORMLU BÜKÜM / FORM TWISTED	64	250
ES-206-02	METALİK / METALIC COLOR	SAC METAL / SHEET METAL	DÜZ BÜKÜM / FLAT TWISTED	60.50	250

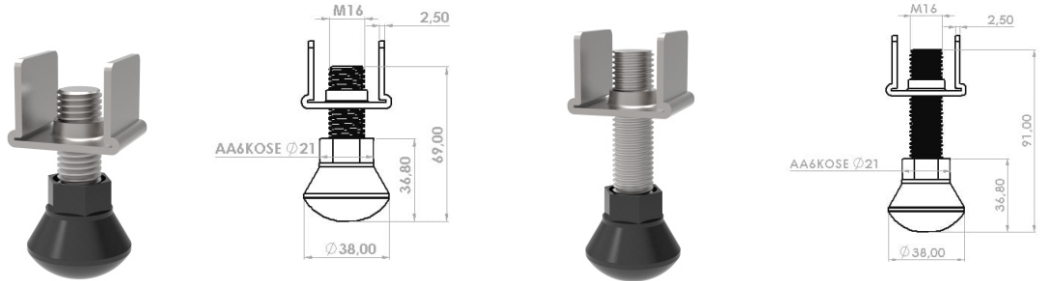

40x40 M16 FORMLU SAC BOMBE AYAKLAR/40X40 M16 FORM METAL SHEET DISHED FEETS

KODU / CODE	RENK / COLOR	MALZEME / MATERIAL	TİP / TYPE	AĞIRLIK / WEIGHT/GR	AD / PCS
ES-206-01-M1650B	METALİK/METALLIC COLOR	HRP	M16X50 BOMBE AYAK/M16X50 DISHED FEET	178	200
ES-206-01-M1670B	METALİK/METALLIC COLOR	HRP	M16X70 BOMBE AYAK/M16X70 DISHED FEET	204	200

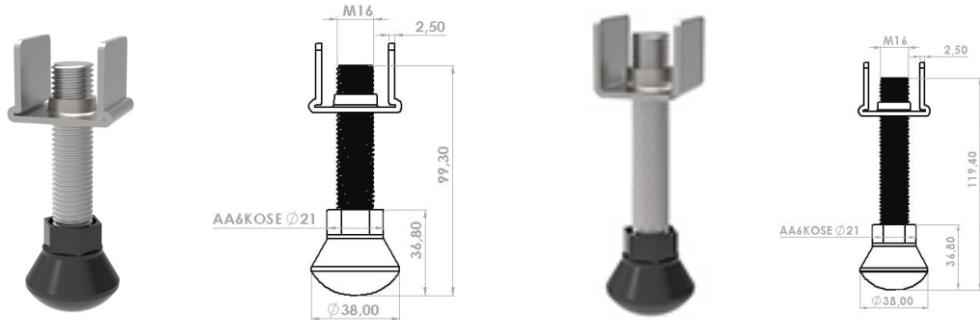

40x40 M16 FORMLU SAC BOMBE AYAKLAR/40X40 M16 FORM METAL SHEET DISHED FEETS

KODU / CODE	RENK / COLOR	MALZEME / MATERIAL	TİP / TYPE	AĞIRLIK / WEIGHT/GR	AD / PCS
ES-206-01-M16100B	METALİK/METALLIC COLOR	HRP	M16X50 BOMBE AYAK/M16X50 DISHED FEET	217	200
ES-206-01-M16120B	METALİK/METALLIC COLOR	HRP	M16X70 BOMBE AYAK/M16X70 DISHED FEET	242.50	200

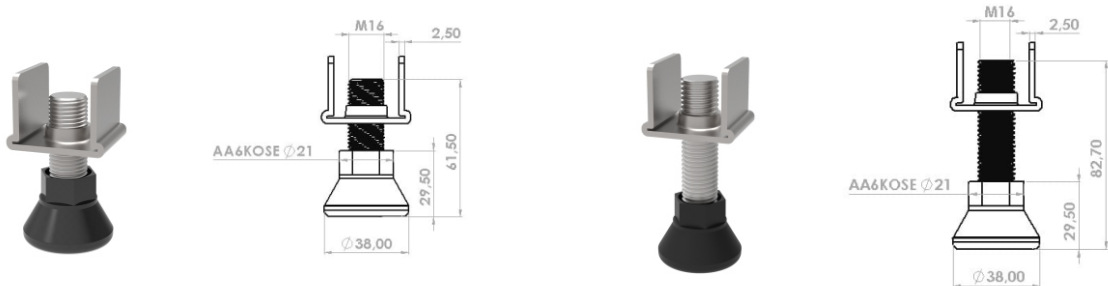

40x40 M16 FORMLU SAC DÜZ AYAKLAR/40X40 M16 FORM METAL SHEET FLAT FEETS

KODU / CODE	RENK / COLOR	MALZEME / MATERIAL	TİP / TYPE	AĞIRLIK / WEIGHT/GR	AD / PCS
ES-206-01-M1650B	METALİK/METALLIC COLOR	HRP	M16X50 DÜZ AYAK/M16X50 FLAT FEET	175	200
ES-206-01-M1670B	METALİK/METALLIC COLOR	HRP	M16X70 DÜZ AYAK/M16X70 FLAT FEET	199	200

ENDÜSTRİYEL MUTFAK GRUBU / THE GROUPS OF INDUSTRIAL KITCHEN

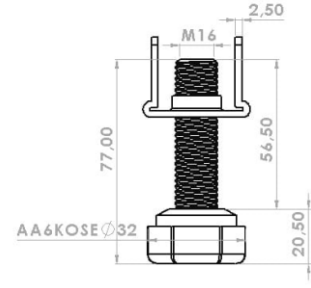
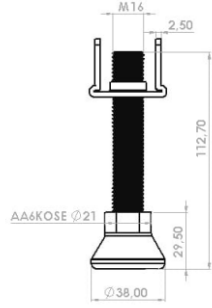

40x40 M16 FORMLU SAC DÜZ AYAKLAR/40X40 M16 FORM METAL SHEET FLAT FEETS

KODU / CODE	RENK / COLOR	MALZEME / MATERIAL	TİP / TYPE	AĞIRLIK / WEIGHT/GR	AD / PCS
ES-206-01-M16100D	METALİK/METALLIC COLOR	HRP	M16X100 DÜZ AYAK/M16X100 FLAT FEET	213	200
ES-206-01-M1665G	METALİK/METALLIC COLOR	HRP	M16X65 6 KÖŞE AYAK/M16X65 6 CORNERS FEET	189	200

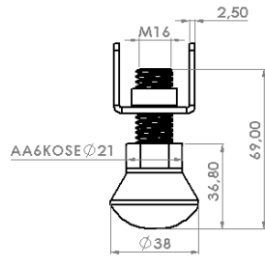

40x40 M16 DÜZ SAC GÖVDE BOMBE AYAK /40X40 M16 FLAT METAL SHEET DISHED FEETS

KODU / CODE	RENK / COLOR	MALZEME / MATERIAL	TİP / TYPE	AĞIRLIK / WEIGHT/GR	AD / PCS
ES-206-02-M1650B	METALİK/METALLIC COLOR	HRP	M16X50 BOMBE AYAK/M16X50 DISHED FEETS	175	200
ES-206-02-M1670B	METALİK/METALLIC COLOR	HRP	M16X70 BOMBE AYAK/M16X70 DISHED FEETS	200	200

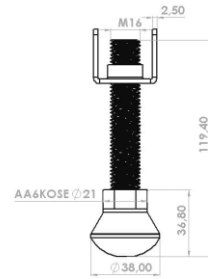

40x40 M16 DÜZ SAC GÖVDE BOMBE AYAK /40X40 M16 FLAT METAL SHEET DISHED FEETS

KODU / CODE	RENK / COLOR	MALZEME / MATERIAL	TİP / TYPE	AĞIRLIK / WEIGHT/GR	AD / PCS
ES-206-02-M16100B	METALİK/METALLIC COLOR	HRP	M16X50 BOMBE AYAK/M16X50 DISHED FEETS	214	200
ES-206-02-M16120B	METALİK/METALLIC COLOR	HRP	M16X70 BOMBE AYAK/M16X70 DISHED FEETS	240	200

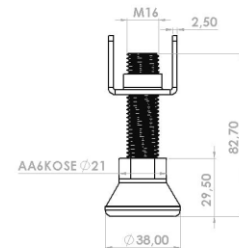
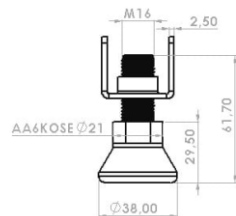

40x40 M16 DÜZ SAC GÖVDE DÜZ AYAK /40X40 M16 FLAT METAL SHEET FLAT FEETS

KODU / CODE	RENK / COLOR	MALZEME / MATERIAL	TİP / TYPE	AĞIRLIK / WEIGHT/GR	AD / PCS
ES-206-02-M1650D	METALİK/METALLIC COLOR	HRP	M16X50 DÜZ AYAK/M16X50 FLAT FEET	170	200
ES-206-02-M1670D	METALİK/METALLIC COLOR	HRP	M16X70 DÜZ AYAK/M16X70 FLAT FEET	197	200

ENDÜSTRİYEL MUTFAK GRUBU / THE GROUPS OF INDUSTRIAL KITCHEN



40x40 M16 DÜZ SAC GÖVDE DÜZ AYAK / 40X40 M16 FLAT METAL SHEET FLAT FEET

KODU / CODE	RENK / COLOR	MALZEME / MATERIAL	TİP / TYPE	AĞIRLIK / WEIGHT/GR	AD / PCS
ES-206-02-M16100 D	METALİK/METALLIC COLOR	HRP	M16X100 DÜZ AYAK/M16X100 FLAT FEET	209	200
ES-206-02-M1665S	METALİK/METALLIC COLOR	HRP	M16X65 ALTI KÖŞE AYAK/M16X65 6 CORNERS FEET	186	200

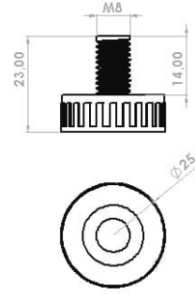

M8X14 DÜZ ÇİVATA / M8X14 FLAT SCREW

KODU / CODE	RENK / COLOR	MALZEME / MATERIAL	TİP / TYPE	AĞIRLIK / WEIGHT/GR	AD / PCS
ES-206-C-M8 15D	SİYAH/BLACK	PP MOBLEN DEMİR VİDA/IRON SCREW	M8X14	13	1000



M16X50 BOMBE ÇİVATA / M16X50 BOLT SCREW

KODU / CODE	RENK / COLOR	MALZEME / MATERIAL	TİP / TYPE	AĞIRLIK / WEIGHT/GR	AD / PCS
ES-206-C-M16 50B	SİYAH / BLACK	PP MOBLEN DEMİR VİDA/IRON SCREW	BOMBE ÇİVATA / BOLT SCREW	117	200

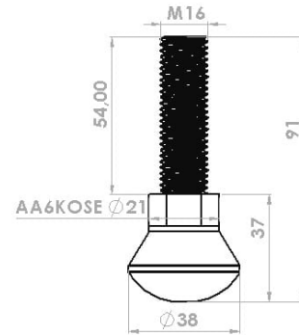

M16X70 BOMBE ÇİVATA / M16X70 BOLT SCREW

KODU / CODE	RENK / COLOR	MALZEME / MATERIAL	TİP / TYPE	AĞIRLIK / WEIGHT/GR	AD / PCS
ES-206-C-M16 70B	SİYAH / BLACK	PP MOBLEN DEMİR VİDA/IRON SCREW	BOMBE ÇİVATA / BOLT SCREW	125	200

ENDÜSTRİYEL MUTFAK GRUBU / THE GROUPS OF INDUSTRIAL KITCHEN



M16X100 BOMBE CİVATA / M16X100 BOLT SCREW

KODU / CODE	RENK / COLOR	MALZEME / MATERIAL	TİP / TYPE	AĞIRLIK / WEIGHT/GR	AD / PCS
ES-206-C-M16 100B	SİYAH / BLACK	PP MOBLEN DEMİR VİDA/IRON SCREW	BOMBE CİVATA / BOLT SCREW	154	200



M16X120 BOMBE CİVATA / M16X120 BOLT SCREW

KODU / CODE	RENK / COLOR	MALZEME / MATERIAL	TİP / TYPE	AĞIRLIK / WEIGHT/GR	AD / PCS
ES-206-C-M16120B	SİYAH / BLACK	PP MOBLEN DEMİR VİDA/IRON SCREW	BOMBE CİVATA / BOLT SCREW	179	200

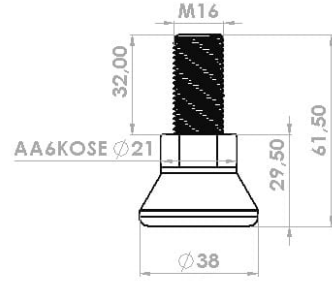

M16X50 DÜZ CİVATA / M16X50 FLAT SCREW

KODU / CODE	RENK / COLOR	MALZEME / MATERIAL	TİP / TYPE	AĞIRLIK / WEIGHT/GR	AD / PCS
ES-206-C-M1650D	SİYAH / BLACK	PP MOBLEN DEMİR VİDA/IRON SCREW	DÜZ CİVATA / FLAT SCREW	179	200

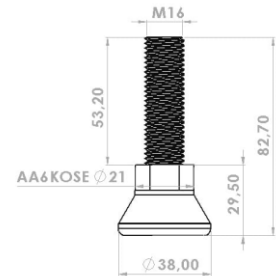

M16X70 DÜZ CİVATA / M16X70 FLAT SCREW

KODU / CODE	RENK / COLOR	MALZEME / MATERIAL	TİP / TYPE	AĞIRLIK / WEIGHT/GR	AD / PCS
ES-206-C-M1670D	SİYAH / BLACK	PP MOBLEN DEMİR VİDA/IRON SCREW	DÜZ CİVATA / FLAT SCREW	137	200

ENDÜSTRİYEL MUTFAK GRUBU / THE GROUPS OF INDUSTRIAL KITCHEN

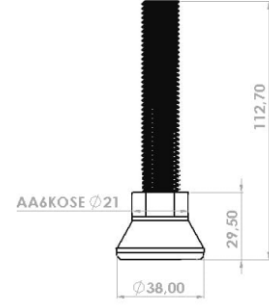

M16X100 DÜZ CİVATA / M16X100 FLAT SCREW

KODU / CODE	RENK / COLOR	MALZEME / MATERIAL	TİP / TYPE	AĞIRLIK / WEIGHT/GR	AD / PCS
ES-206-C-M16100D	SİYAH / BLACK	PP MOBLEN DEMİR VİDA/IRON SCREW	DÜZ CİVATA / FLAT SCREW	165	200

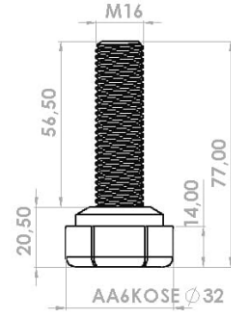

M16X65 6 KÖŞE CİVATA / M16X65 6 CORNERS SCREW

KODU / CODE	RENK / COLOR	MALZEME / MATERIAL	TİP / TYPE	AĞIRLIK / WEIGHT/GR	AD / PCS
ES-206-C-M1665S	SİYAH / BLACK	ABS DEMİR VİDA/IRON SCREW	6 KÖŞE CİVATA / 6 CORNERS SCREW	179	200
ES-206-C-M1665G	GİRİ / GRAY	ABS DEMİR VİDA/IRON SCREW	6 KÖŞE CİVATA / 6 CORNERS SCREW	179	200

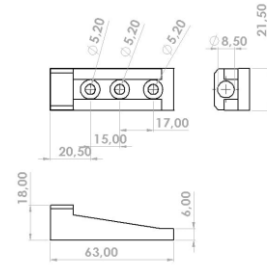

ÇEKTİRME APARATI / PULLING DEVICE

KODU / CODE	RENK / COLOR	MALZEME / MATERIAL	TİP / TYPE	AĞIRLIK / WEIGHT/GR	AD / PCS
ES-262-01	METALİK GİRİ / METALLIC GRAY	ZAMAK / ZINC	3 DELİKLİ / 3 HOLES	76	500

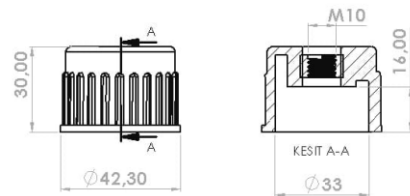

BORU İÇİ APARAT ÇAP 42 / IN PIPE DEVICE DIAMETER 42

KODU / CODE	RENK / COLOR	MALZEME / MATERIAL	TİP / TYPE	AĞIRLIK / WEIGHT/GR	AD / PCS
ES-258-01	GİRİ / GRAY	ABS	ÇAP 42 / DIAMETER 42	26,5	500

ENDÜSTRİYEL MUTFAK GRUBU / THE GROUPS OF INDUSTRIAL KITCHEN



KÖŞE KORUYUCU / CORNER GUARD

KODU / CODE	RENK / COLOR	MALZEME / MATERIAL	TİP / TYPE	AĞIRLIK / WEIGHT/GR	AD / PCS
ES-262-02	GRİ/GREY	LASTİK/TYRE	93X96 mm		100



DIKEY BUZDOLABI KİLİDİ / VERTICAL REFRIGERATOR LOCK

KODU / CODE	RENK / COLOR	MALZEME / MATERIAL	TİP / TYPE	AĞIRLIK / WEIGHT/GR	AD / PCS
ES-264-01	GRİ/GREY	ALÜMİNYUM/ ALUMINUM	STANDART		1



SÜRGÜLÜ DOLAP YAYI / SLIDING REFRIGERATOR SPRING

KODU / CODE	RENK / COLOR	MALZEME / MATERIAL	TİP / TYPE	AĞIRLIK / WEIGHT/GR	AD / PCS
ES-267-01	METALİK/METALIC	ÇELİK/STEEL	ÇAP 6		1

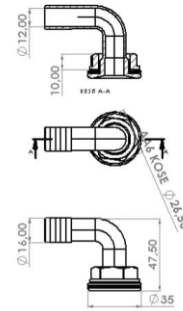

90 DERECE SU TAHLİYE DİRSEĞİ S/SLIDING REFRIGERATOR SPRING

KODU / CODE	RENK / COLOR	MALZEME / MATERIAL	TİP / TYPE	AĞIRLIK / WEIGHT/GR	AD / PCS
ES-209-08	SİYAH/BLACK	NV6	90 DERECE	14,5	1000

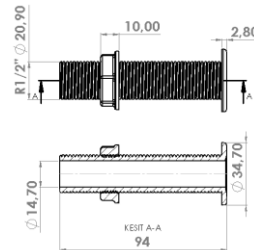

1/2" SU GİDERLERİ / WATER DISCHARGING PIPES

KODU / CODE	RENK / COLOR	MALZEME / MATERIAL	TİP / TYPE	AĞIRLIK / WEIGHT/GR	AD / PCS
ES-209-01	SİYAH / BLACK	ABS	TAPASIZ/WITHOUT COVER	21	350
ES-209-01N	SİYAH / BLACK	PA6	TAPASIZ/WITHOUT COVER	21	350
ES-209-01ST	SİYAH / BLACK	ABS	TAPALI/WITH COVER	23	350

ENDÜSTRİYEL MUTFAK GRUBU / THE GROUPS OF INDUSTRIAL KITCHEN

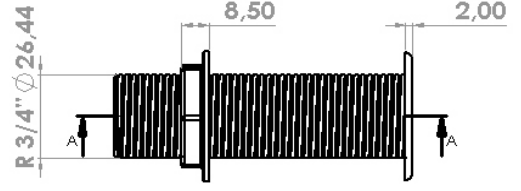
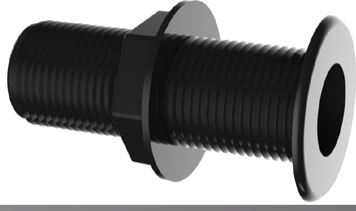

3/4" SU GİDERLERİ / 3/4" WATER EXPENSES

KODU / CODE	RENK / COLOR	MALZEME / MATERIAL	TİP / TYPE	AĞIRLIK / WEIGHT/GR	AD / PCS
ES-209-02	SİYAH/BLACK	ABS	TAPASIZ/WITHOUT COVER	20	250
ES-209-02N	SİYAH/BLACK	PA6	TAPASIZ/WITHOUT COVER	20	250
ES-209-02ST	SİYAH/BLACK	ABS	TAPALI/WITH COVER	23	250
ES-209-02BT	BEYAZ/WHITE	ABS	TAPALI/WITH COVER	23	250
ES-209-02B	BEYAZ/WHITE	ABS	TAPASIZ/WITHOUT COVER	23	250

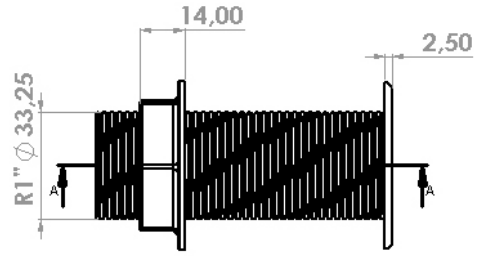

1" SU GİDERLERİ / WATER DISCHARGING PIPES

KODU / CODE	RENK / COLOR	MALZEME / MATERIAL	TİP / TYPE	AĞIRLIK / WEIGHT/GR	AD / PCS
ES-209-03	SİYAH / BLACK	ABS	TAPASIZ/WITHOUT COVER	32,5	125
ES-209-03N	SİYAH / BLACK	PA6	TAPASIZ/WITHOUT COVER	32,5	125
ES-209-03ST	SİYAH / BLACK	ABS	TAPALI/WITH COVER	35,5	125

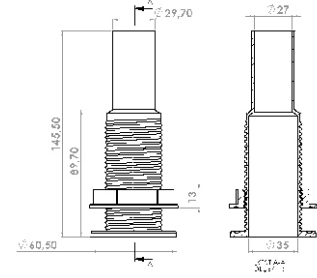

SU GİDERİ 35mm / WATER DISCHARGING PIPES 35mm

KODU / CODE	RENK / COLOR	MALZEME / MATERIAL	TİP / TYPE	AĞIRLIK / WEIGHT/GR	AD / PCS
ES-209-04	SİYAH / BLACK	ABS	CONTASIZ/WITHOUT GASKET	41	150
ES-209-05	SİYAH / BLACK	ABS	CONTALI/GASKET	46	150

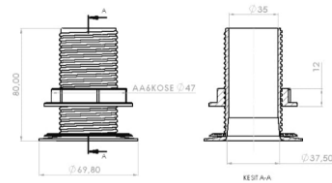

SU GİDERİ KISA 35mm / SHORT WATER DISCHARGING PIPES 35mm

KODU / CODE	RENK / COLOR	MALZEME / MATERIAL	TİP / TYPE	AĞIRLIK / WEIGHT/GR	AD / PCS
ES-209-08DC	SİYAH / BLACK	PA6	CONTALI/GASKET	42	200
ES-209-09DC	SİYAH / BLACK	PA6	ÇİFT CONTALI/ DOUBLE GASKETS	45	200

ENDÜSTRİYEL MUTFAK GRUBU / THE GROUPS OF INDUSTRIAL KITCHEN

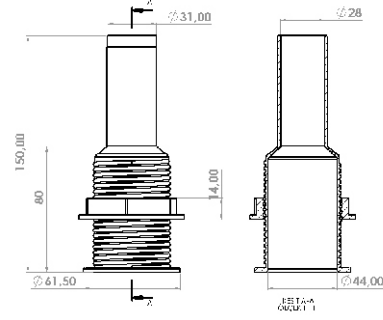

SU GİDERİ 45mm / WATER DISCHARGING PIPES 45mm

KODU / CODE	RENK / COLOR	MALZEME / MATERIAL	TİP / TYPE	AĞIRLIK / WEIGHT/GR	AD / PCS
ES-209-06	SİYAH / BLACK	ABS	CONTASIZ / WITHOUT GASKET	49,5	100

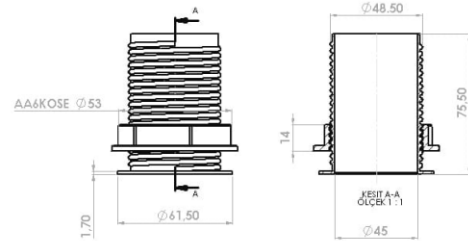

SU GİDERİ KISA 45mm / SHORT WATER DISCHARGING PIPES 45mm

KODU / CODE	RENK / COLOR	MALZEME / MATERIAL	TİP / TYPE	AĞIRLIK / WEIGHT/GR	AD / PCS
ES-209-07	SİYAH / BLACK	PP	CONTASIZ / WITHOUT GASKET	34	200

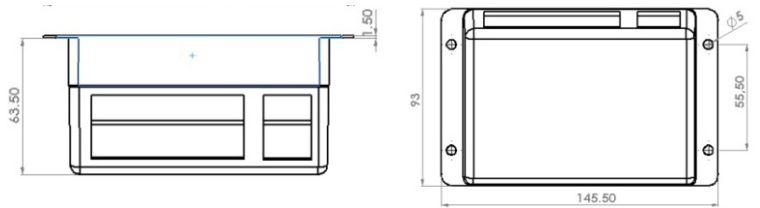

AŞAĞI EĞİMLİ BOMBE KUTUSU 1 GÖZ / DAIRY FRIDGE DIGITAL CONTROL INSIDE

KODU / CODE	RENK / COLOR	MALZEME / MATERIAL	TİP / TYPE	AĞIRLIK / WEIGHT/GR	AD / PCS
ES-209-1S	SİYAH / BLACK	ABS	1 GÖZ / SINGLE BUTTON	79.5	60
ES-209-1B	BEYAZ / WHITE	ABS	1 GÖZ / SINGLE BUTTON	79.5	60
ES-209-1A	ANTRASİT / ANTHRACITE	ABS	1 GÖZ / SINGLE BUTTON	79.5	60

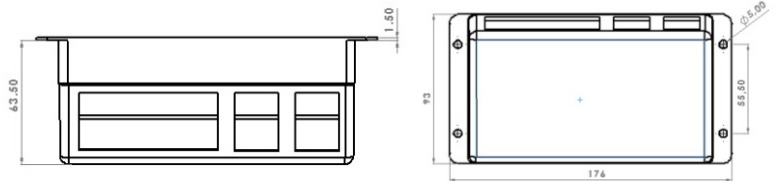

AŞAĞI EĞİMLİ BOMBE KUTUSU 2 GÖZ / DAIRY FRIDGE DIGITAL CONTROL INSIDE

KODU / CODE	RENK / COLOR	MALZEME / MATERIAL	TİP / TYPE	AĞIRLIK / WEIGHT/GR	AD / PCS
ES-209-2S	SİYAH / BLACK	ABS	2 GÖZ / DOUBLE BUTTONS	91	60
ES-209-2B	BEYAZ / WHITE	ABS	2 GÖZ / DOUBLE BUTTONS	91	60
ES-209-2A	ANTRASİT / ANTHRACITE	ABS	2 GÖZ / DOUBLE BUTTONS	91	60

ENDÜSTRİYEL MUTFAK GRUBU / THE GROUPS OF INDUSTRIAL KITCHEN

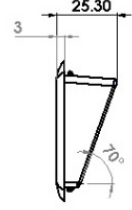
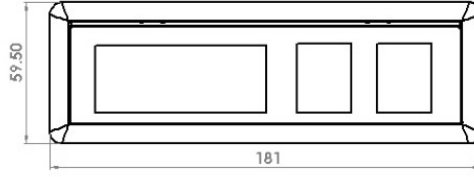

EĞİMLİ PANO KUTUSU ÇİFT BUTON / SLOPE DIGITAL CONTROL UNIT DOUBLE BUTTON /

KODU / CODE	RENK / COLOR	MALZEME / MATERIAL	TİP / TYPE	AĞIRLIK / WEIGHT/GR	AD / PCS
ES-207-02G	GRİ / GRAY	ABS	ÇİFT BUTON CAMSIZ / DOUBLE BUTTON WITHOUT GLASS	35	100
ES-207-02S	SİYAH / BLACK	ABS	ÇİFT BUTON CAMSIZ / DOUBLE BUTTON WITHOUT GLASS	35	100
ES-207-02A	ANTRASİT / ANTHRACITE	ABS	ÇİFT BUTON CAMSIZ / DOUBLE BUTTON WITHOUT GLASS	35	100

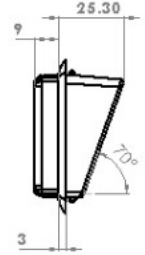
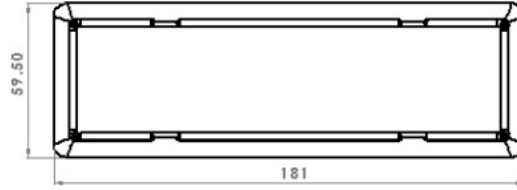

EĞİMLİ PANO KUTUSU ÇİFT GÖZLÜ / SLOPE DIGITAL CONTROL UNIT WITH GLASS DOUBLE BUTTON /

KODU / CODE	RENK / COLOR	MALZEME / MATERIAL	TİP / TYPE	AĞIRLIK / WEIGHT/GR	AD / PCS
ES-207-02GC	GRİ / GRAY	ABS / POLİKARBONAT	ÇİFT BUTON CAMLI / DOUBLE BUTTON WITH GLASS	35	100
ES-207-02SC	SİYAH / BLACK	ABS / POLİKARBONAT	ÇİFT BUTON CAMLI / DOUBLE BUTTON WITH GLASS	35	100
ES-207-02AC	ANTRASİT / ANTHRACITE	ABS / POLİKARBONAT	ÇİFT BUTON CAMLI / DOUBLE BUTTON WITH GLASS	35	100

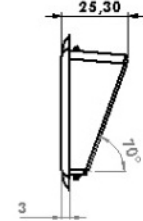
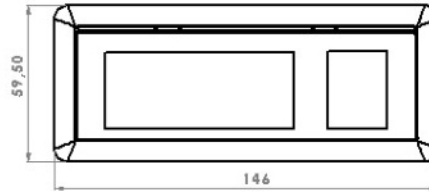

EĞİMLİ PANO KUTUSU TEK GÖZLÜ / SLOPE DIGITAL CONTROL UNIT WITH GLASS SINGLE BUTTON /

KODU / CODE	RENK / COLOR	MALZEME / MATERIAL	TİP / TYPE	AĞIRLIK / WEIGHT/GR	AD / PCS
ES-207-01S	SİYAH / BLACK	ABS	TEK BUTON CAMSIZ / SINGLE BUTTON WITHOUT GLASS	35	100
ES-207-01G	GRİ / GRAY	ABS	TEK BUTON CAMSIZ / SINGLE BUTTON WITHOUT GLASS	35	100
ES-207-01A	ANTRASİT / ANTHRACITE	ABS	TEK BUTON CAMSIZ / SINGLE BUTTON WITHOUT GLASS	35	100

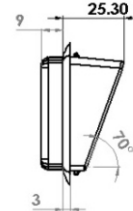
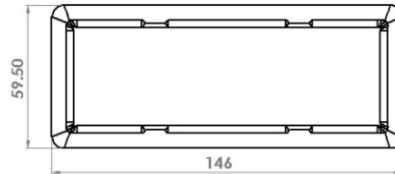

EĞİMLİ CAMLI PANO KUTUSU TEK GÖZLÜ / SLOPE DIGITAL CONTROL UNIT WITH GLASS SINGLE BUTTON /

KODU / CODE	RENK / COLOR	MALZEME / MATERIAL	TİP / TYPE	AĞIRLIK / WEIGHT/GR	AD / PCS
ES-207-01GC	GRİ / GRAY	ABS / POLİKARBONAT	TEK BUTON CAMLI / SINGLE BUTTON WITH GLASS	35	100
ES-207-01SC	SİYAH / BLACK	ABS / POLİKARBONAT	TEK BUTON CAMLI / SINGLE BUTTON WITH GLASS	35	100
ES-207-01AC	ANTRASİT / ANTHRACITE	ABS / POLİKARBONAT	TEK BUTON CAMLI / SINGLE BUTTON WITH GLASS	35	100

ENDÜSTRİYEL MUTFAK GRUBU / THE GROUPS OF INDUSTRIAL KITCHEN

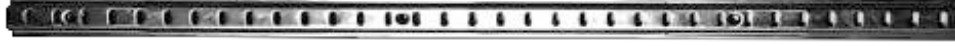

DİKME / VERTICAL REFRIGERATION SHELF SUPPORTS

KODU / CODE	RENK / COLOR	MALZEME / MATERIAL	TİP / TYPE	AĞIRLIK / WEIGHT/GR	AD / PCS
ES-210-100	INOX	304 STAINLESS STEEL	100CM	200	
ES-210-120	INOX	304 STAINLESS STEEL	120CM	240	
ES-210-150	INOX	304 STAINLESS STEEL	150CM	300	
ES-210-200	INOX	304 STAINLESS STEEL	200CM	400	

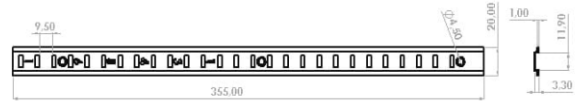

ALÜMİNYUM DİKME 35,5 cm / VERTICAL REFRIGERATION SHELF SUPPORTS 35,5 cm

KODU / CODE	RENK / COLOR	MALZEME / MATERIAL	TİP / TYPE	AĞIRLIK / WEIGHT/GR	AD / PCS
EC-210-35	METALİK/METALIC	ALÜMİNYUM/ALUMINUM	35,5 cm	23,5	100
EC-210-100A	METALİK/METALIC	ALÜMİNYUM/ALUMINUM	100 cm	66	100
EC-210-120A	METALİK/METALIC	ALÜMİNYUM/ALUMINUM	120 cm	78	100
EC-210-150A	METALİK/METALIC	ALÜMİNYUM/ALUMINUM	150 cm	97	100



KANCA / STAINLESS STEEL SHELF HOLDER

KODU / CODE	RENK / COLOR	MALZEME / MATERIAL	TİP / TYPE	AĞIRLIK / WEIGHT/GR	AD / PCS
ES-211-01	INOX	304 STAINLESS STEEL	MODEL 1	12	500
ES-211-02	INOX	304 STAINLESS STEEL	MODEL 2	12	500



3X1.5 FİŞLİ KABLO / 3X1.5 PLUB CABLE

KODU / CODE	RENK / COLOR	MALZEME / MATERIAL	TİP / TYPE	AĞIRLIK / WEIGHT/GR	AD / PCS
ES-248-01	SİYAH/BLACK	COPPER+ PVC	3 MT	450	1
ES-248-02	SİYAH/BLACK	COPPER+ PVC	2,5 MT	400	1



DİJİTAL TERMOSTAT / DIGITAL THERMOSTAT

KODU / CODE	RENK / COLOR	MALZEME / MATERIAL	TİP / TYPE	AĞIRLIK / WEIGHT/GR	AD / PCS
ES-249-01	SİYAH/BLACK	ABS	TEK TROP		1
ES-249-02	SİYAH/BLACK	ABS	ÇİFT TROP		1

ENDÜSTRİYEL MUTFAK GRUBU / THE GROUPS OF INDUSTRIAL KITCHEN



AÇ KAPA ANAHTARLAR / SWITCH BUTTONS

KODU / CODE	RENK / COLOR	MALZEME / MATERIAL	TİP / TYPE	AĞIRLIK / WEIGHT/GR	AD / PCS
ES-212-SK01	KIRMIZI / RED	P66	KIRMIZI I-0 / ON-OFF BUTTON	12.5	200
ES-212-SKF	KIRMIZI / RED	P66	KIRMIZI FAN / FAN SWITCH BUTTON	12.5	200
ES-212-SSL	SARI / YELLOW	P66	SARI LAMBA / LIGHT SWITCH BUTTON	12.5	200
ES-212-SYK	YEŞİL / GREEN	P66	YEŞİL KAR / MOTOR SWITCH BUTTON	12.5	200
ES-212-SBL	BEYAZ / WHITE	P66	BEYAZ LAMBA / LIGHT SWITCH BUTTON	12.5	200



KÖRÜKLÜ ŞALTERLER / WATER PROOF SWITCH BUTTONS

KODU / CODE	RENK / COLOR	MALZEME / MATERIAL	TİP / TYPE	AĞIRLIK / WEIGHT/GR	AD / PCS
ES-213-KK01	KIRMIZI / RED	P66	KIRMIZI 0-1 / ON-OFF BUTTON	13	100
ES-213-KKF	KIRMIZI / RED	P66	KIRMIZI FAN / FAN SWITCH BUTTON	13	100
ES-213-KSL	SARI / YELLOW	P66	SARI LAMBA / LIGHT SWITCH BUTTON	13	100
ES-213-KYK	YEŞİL / GREEN	P66	YEŞİL KAR / MOTOR SWITCH BUTTON	13	100
ES-213-KS01	SİYAH / BLACK	P66	SİYAH 0-1 / LIGHT SWITCH BUTTON	13	100



İNCE ŞALTER / THIN SWITCH BUTTONS

KODU / CODE	RENK / COLOR	MALZEME / MATERIAL	TİP / TYPE	AĞIRLIK / WEIGHT/GR	AD / PCS
ES-214-01	KIRMIZI / RED	P66	TEKLI İNCE / SINGLE BUTTON		200
ES-214-02	KIRMIZI / RED	P66	ÇİFTLİ İNCE / DOUBLE BUTTONS		200
ES-214-04	KIRMIZI / RED	P66	TEKLI İNCE (IŞIKLI) / SINGLE BUTTON WITH LIGHT		200
ES-214-05	KIRMIZI / RED	P66	ÇİFTLİ İNCE (IŞIKLI) / DOUBLE BUTTONS WITH LIGHT		200



SİMGELİ ANAHTARLAR / INSIDE SWITCH BUTTONS WITH LIGHT

KODU / CODE	RENK / COLOR	MALZEME / MATERIAL	TİP / TYPE	AĞIRLIK / WEIGHT/GR	AD / PCS
ES-215-01	BEYAZ / WHITE	P66	AÇ KAPA / ON-OFF BUTTON		100
ES-215-02	SİYAH / BLACK	P66	AÇ KAPA / ON-OFF BUTTON		100



YUVARLAK ANAHTAR / ROUND SWITCH BUTTON

KODU / CODE	RENK / COLOR	MALZEME / MATERIAL	TİP / TYPE	AĞIRLIK / WEIGHT/GR	AD / PCS
ES-216-01	KIRMIZI / RED	P 66	YUVARLAK MODEL / ROUND MODEL	5	100

ENDÜSTRİYEL MUTFAK GRUBU / THE GROUPS OF INDUSTRIAL KITCHEN



RULMAN TEKERLER / BEARING WHEEL

KODU / CODE	RENK / COLOR	MALZEME / MATERIAL	TİP / TYPE	AĞIRLIK / WEIGHT/GR	AD / PCS
ES-250-01	SİYAH/BLACK	PA6	ÇAP 20/ DIAMETER 20		100
ES-250-02	SİYAH/BLACK	PA6	ÇAP 30/ DIAMETER 30		100
ES-250-03	SİYAH/BLACK	PA6	ÇAP 40/ DIAMETER 40		100

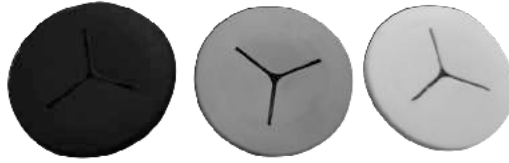

YUMUŞAK TAVA LASTİĞİ / SOFT RESERVOIR TIRE

KODU / CODE	RENK / COLOR	MALZEME / MATERIAL	TİP / TYPE	AĞIRLIK / WEIGHT/GR	AD / PCS
ES-218-S	SİYAH / BLACK	PVC	STANDARD MODEL	5	500
ES-218-G	GRİ / GRAY	PVC	STANDARD MODEL	5	500
ES-218-P	PETROL GRİ / PETROLEUM GRAY	PVC	STANDARD MODEL	5	500

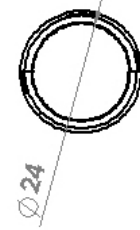
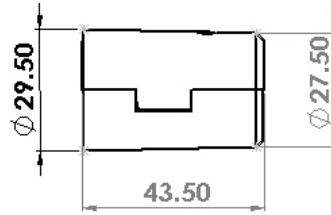

PLASTİK RAF TUTUCU / PLASTIC SHELF HOLDER

KODU / CODE	RENK / COLOR	MALZEME / MATERIAL	TİP / TYPE	AĞIRLIK / WEIGHT/GR	AD / PCS
ES-221-01	SİYAH/BLACK	ABS	STANDART MODEL	10	500

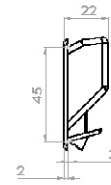
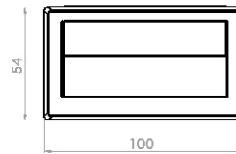
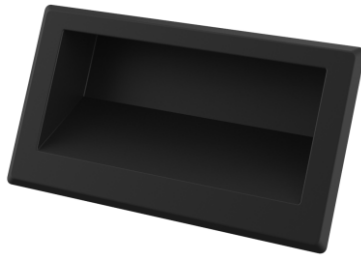

PLASTİK GÖMME KULP / PLASTIC RECESSED HANDLE

KODU / CODE	RENK / COLOR	MALZEME / MATERIAL	TİP / TYPE	AĞIRLIK / WEIGHT/GR	AD / PCS
ES-244-01	SİYAH/BLACK	PA6	100 mm	31,5	200

ENDÜSTRİYEL MUTFAK GRUBU / THE GROUPS OF INDUSTRIAL KITCHEN

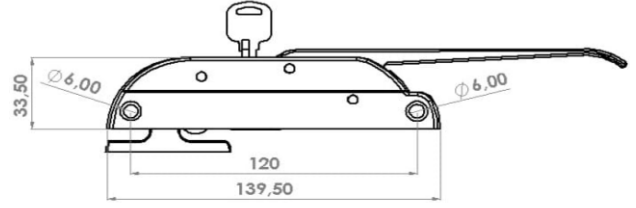

OVAL YAN KİLİT ANAHTARLI ZAMAK KOL / OVAL SIDE LOCK KEY ZAMAK HANDLE

KODU / CODE	RENK / COLOR	MALZEME / MATERIAL	TİP / TYPE	AĞIRLIK / WEIGHT/GR	AD / PCS
ES-222-03	KROM/CHROMIUM	ZAMAK 5 / ZINCS	ANAHTARLI/ WITH KEY	359,50 gr	40

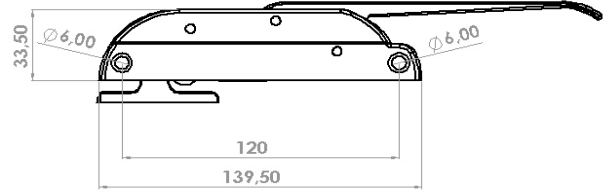

OVAL YAN KİLİT ANAHTARSIZ ZAMAK KOL / OVAL SIDE LOCK KEYLESS ZAMAK HANDLE

KODU / CODE	RENK / COLOR	MALZEME / MATERIAL	TİP / TYPE	AĞIRLIK / WEIGHT/GR	AD / PCS
ES-222-04	KROM/CHROMIUM	ZAMAK 5 / ZINCS	ZAMAK KOL/ZAMAK ARM	317,5 gr	40

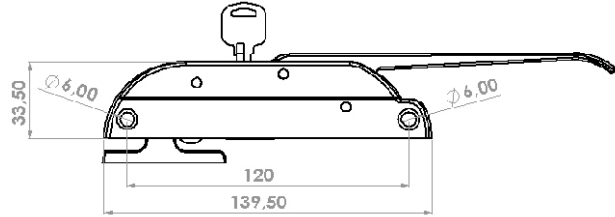
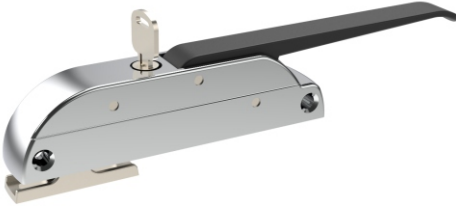

OVAL YAN KİLİT ANAHTARLI PLASTİK KOL / OVAL PLASTIC HANDLE WITH SIDE LOCK SWITCH

KODU / CODE	RENK / COLOR	MALZEME / MATERIAL	TİP / TYPE	AĞIRLIK / WEIGHT/GR	AD / PCS
ES 222-05	KROM/CHROMIUM	ZAMAK 5 / ZINCS	PLASTİK KOL / PLASTIC ARM	303	40

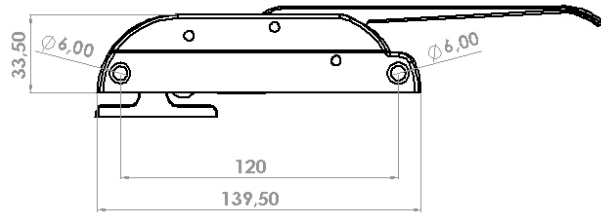

OVAL YAN KİLİT ANAHTARSIZ PLASTİK KOL / OVAL PLASTIC HANDLE KEYLESS PLASTIC ARM

KODU / CODE	RENK / COLOR	MALZEME / MATERIAL	TİP / TYPE	AĞIRLIK / WEIGHT/GR	AD / PCS
ES 222-06	KROM/CHROMIUM	ZAMAK 5 / ZINCS	PLASTİK KOL / PLASTIC ARM	264	40

ENDÜSTRİYEL MUTFAK GRUBU / THE GROUPS OF INDUSTRIAL KITCHEN

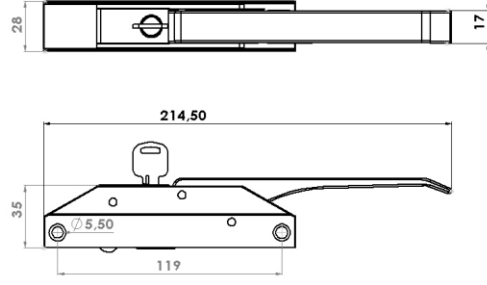
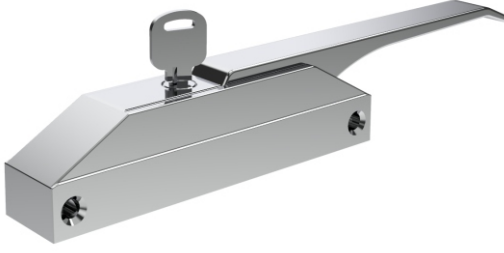

YAN KİLİT ANAHTARLI ZAMAK KOL / SIDE LOCK KEY ZAMAK HANDLE

KODU / CODE	RENK / COLOR	MALZEME / MATERIAL	TİP / TYPE	AĞIRLIK / WEIGHT/GR	AD / PCS
ES-222-01	KROM/CHROMIUM	ZAMAK 5 / ZINCS	STANDART MODEL / STANDART MODEL	334	1

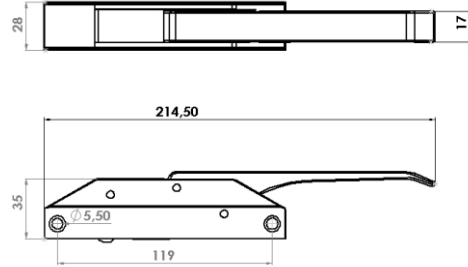
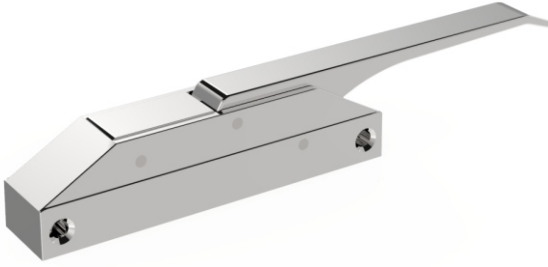

YAN KİLİT ANAHTARSIZ ZAMAK KOL / SIDE LOCK KEYLESS ZAMAK HANDLE

KODU / CODE	RENK / COLOR	MALZEME / MATERIAL	TİP / TYPE	AĞIRLIK / WEIGHT/GR	AD / PCS
ES-222-02	KROM/CHROMIUM	ZAMAK 5 / ZINCS	STANDART MODEL / STANDART MODEL	353	1

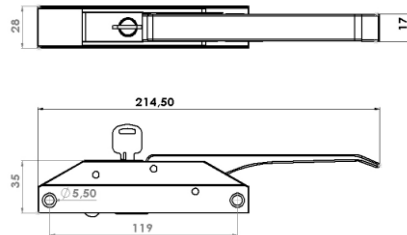
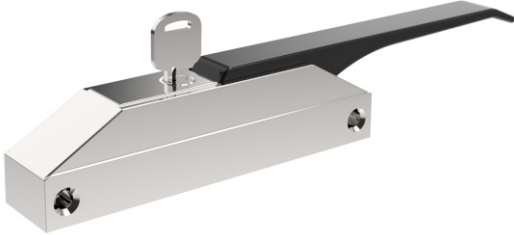

YAN KİLİT ANAHTARLI PLASTİK KOL / PLASTIC HANDLE WITH SIDE LOCK SWITCH

KODU / CODE	RENK / COLOR	MALZEME / MATERIAL	TİP / TYPE	AĞIRLIK / WEIGHT/GR	AD / PCS
ES-223-01	KROM/CHROMIUM	ZAMAK 5 / ZINCS	STANDART MODEL / STANDART MODEL	257	1

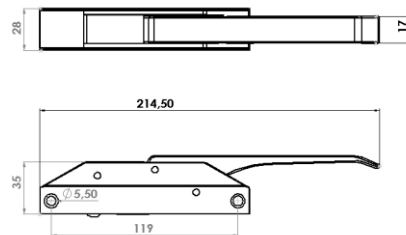

YAN KİLİT ANAHTARSIZ PLASTİK KOL / PLASTIC HANDLE WITH SIDE LOCK SWITCH

KODU / CODE	RENK / COLOR	MALZEME / MATERIAL	TİP / TYPE	AĞIRLIK / WEIGHT/GR	AD / PCS
ES-223-02	KROM/CHROMIUM	ZAMAK 5 / ZINCS	PLASTİK KOL / STANDART MODEL	276	1

ENDÜSTRİYEL MUTFAK GRUBU / THE GROUPS OF INDUSTRIAL KITCHEN

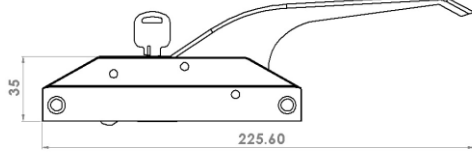

YAN KİLİT ANAHTARLI YÜKSEK ZAMAK KOL / SIDE LOCK WITH KEY HIGHT ZAMAK ARM

KODU / CODE	RENK / COLOR	MALZEME / MATERIAL	TİP / TYPE	AĞIRLIK / WEIGHT/GR	AD / PCS
ES-224-01	KROM/CHROMIUM	ZAMAK 5 / ZINCS	STANDART MODEL / STANDART MODEL	212	1

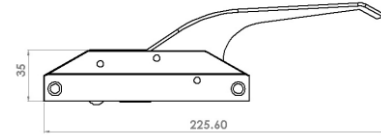

YAN KİLİT ANAHTARSIZ YÜKSEK ZAMAK KOL / SIDE LOCK WITH OUT KEY HIGHT ZAMAK ARM

KODU / CODE	RENK / COLOR	MALZEME / MATERIAL	TİP / TYPE	AĞIRLIK / WEIGHT/GR	AD / PCS
ES-224-02	KROM/CHROMIUM	ZAMAK 5 / ZINCS	STANDART MODEL / STANDART MODEL	212	1

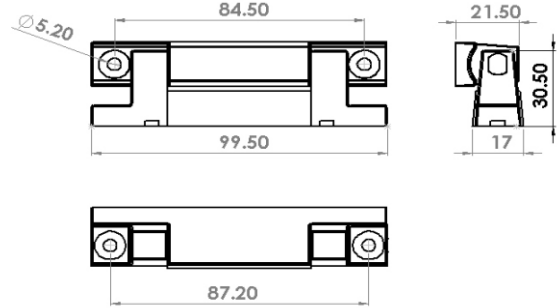
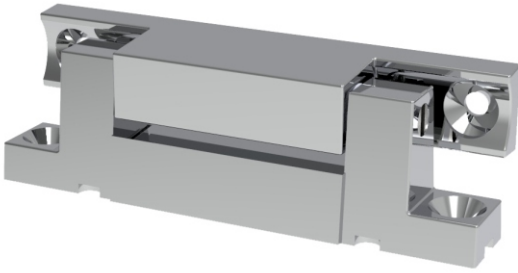

KÖŞELİ YAN MENTEŞE / CORNERED SIDE HINGE

KODU / CODE	RENK / COLOR	MALZEME / MATERIAL	TİP / TYPE	AĞIRLIK / WEIGHT/GR	AD / PCS
ES-228-01	KROM/CHROMIUM	ZAMAK 5 / ZINCS	YAYSIZ MODEL / WITHOUT SPRING	130	100
ES-228-02	KROM/CHROMIUM	ZAMAK 5 / ZINCS	YAYLI MODEL / WITH SPRING	143	100

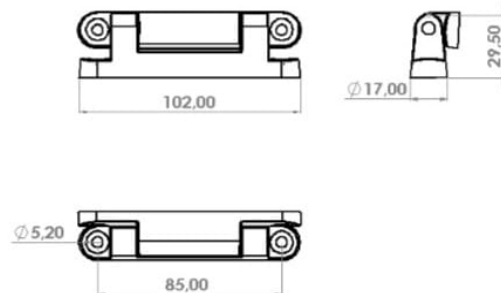
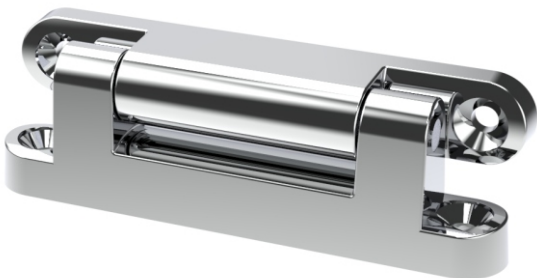

OVAL YAN MENTEŞE / OVAL SIDE HINGE

KODU / CODE	RENK / COLOR	MALZEME / MATERIAL	TİP / TYPE	AĞIRLIK / WEIGHT/GR	AD / PCS
ES-228-03	KROM/CHROMIUM	ZAMAK 5 / ZINCS	YAYSIZ MODEL / WITHOUT SPRING	102	100
ES-228-03	KROM/CHROMIUM	ZAMAK 5 / ZINCS	YAYLI MODEL / WITH SPRING	115	100

ENDÜSTRİYEL MUTFAK GRUBU / THE GROUPS OF INDUSTRIAL KITCHEN

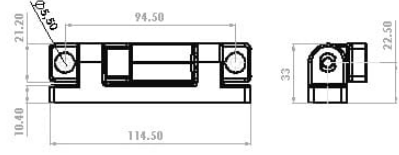
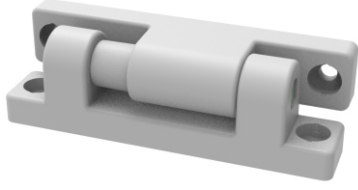

VİTRİN BUZDOLABI MENTEŞE / SPRING HINGED ARM

KODU / CODE	RENK / COLOR	MALZEME / MATERIAL	TİP / TYPE	AĞIRLIK / WEIGHT/GR	AD / PCS
ES-254-01	GRİ/GRAY	Pa6	YAYLI	75	100

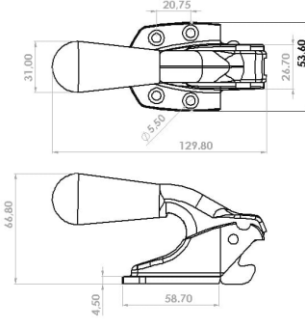

FIRIN KİLİT / OVEN LOCK

KODU / CODE	RENK / COLOR	MALZEME / MATERIAL	TİP / TYPE	AĞIRLIK / WEIGHT/GR	AD / PCS
ES-226-03	KROM/CHROMIUM	ZAMAK 5 / ZINCS	STANDART MODEL / STANDART MODEL	262	40

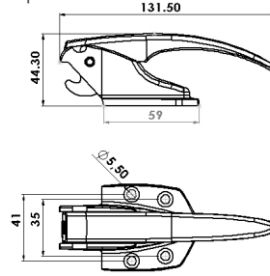

VİTRİN KİLİT / SHOWCASE LOCK

KODU / CODE	RENK / COLOR	MALZEME / MATERIAL	TİP / TYPE	AĞIRLIK / WEIGHT/GR	AD / PCS
ES-226-01	KROM/CHROMIUM	ZAMAK 5 / ZINCS	STANDART MODEL / STANDART MODEL	262	1

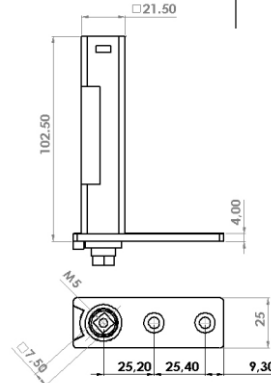

YAYLI MENTEŞE KARE MİL SOL / SPRING HINGE SQUARE SHAFT LEFT

KODU / CODE	RENK / COLOR	MALZEME / MATERIAL	TİP / TYPE	AĞIRLIK / WEIGHT/GR	AD / PCS
ES-227-01	KROM/CHROMIUM	ZAMAK 5 / ZINCS	STANDART MODEL / STANDART MODEL	212	1

ENDÜSTRİYEL MUTFAK GRUBU / THE GROUPS OF INDUSTRIAL KITCHEN

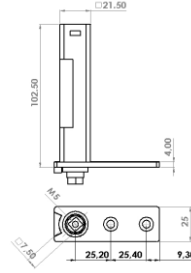

YAYLI MENTEŞE KARE MİL SAĞ / SPRING HINGE SQUARE SHAFT RIGHT

KODU / CODE	RENK / COLOR	MALZEME / MATERIAL	TİP / TYPE	AĞIRLIK / WEIGHT/GR	AD / PCS
ES-227-02	KROM/CHROMIUM	ZAMAK 5 / ZINC5	STANDART MODEL / STANDART MODEL	212	1

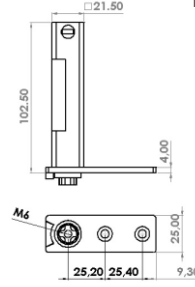
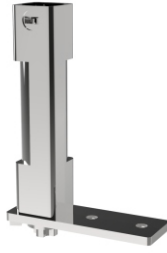

YAYLI MENTEŞE YILDIZ MİL SAĞ / SPRING HINGE STAR SHAFT RIGHT

KODU / CODE	RENK / COLOR	MALZEME / MATERIAL	TİP / TYPE	AĞIRLIK / WEIGHT/GR	AD / PCS
ES-227-03	KROM/CHROMIUM	ZAMAK 5 / ZINC5	STANDART MODEL / STANDART MODEL	1800	1

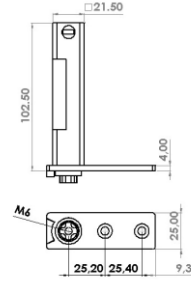

YAYLI MENTEŞE YILDIZ MİL SOL / SPRING HINGE STAR SHAFT LEFT

KODU / CODE	RENK / COLOR	MALZEME / MATERIAL	TİP / TYPE	AĞIRLIK / WEIGHT/GR	AD / PCS
ES-227-04	KROM/CHROMIUM	ZAMAK 5 / ZINC5	STANDART MODEL / STANDART MODEL	276	1

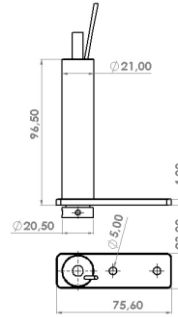

YAYLI MENTEŞE BORU TİP SAĞ / SPRING HINGE PIPE TYPE RIGHT

KODU / CODE	RENK / COLOR	MALZEME / MATERIAL	TİP / TYPE	AĞIRLIK / WEIGHT/GR	AD / PCS
ES-227-05	KROM/CHROMIUM	ZAMAK 5 / ZINC5	STANDART MODEL / STANDART MODEL	212	1

ENDÜSTRİYEL MUTFAK GRUBU / THE GROUPS OF INDUSTRIAL KITCHEN

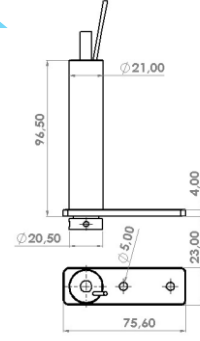

YAYLI MENTEŞE BORU TİP SAĞ / SPRING HINGE PIPE TYPE RIGHT

KODU / CODE	RENK / COLOR	MALZEME / MATERIAL	TİP / TYPE	AĞIRLIK / WEIGHT/GR	AD / PCS
ES-227-06	KROM/CHROMIUM	ZAMAK 5 / ZINCS	STANDART MODEL / STANDART MODEL	212	1

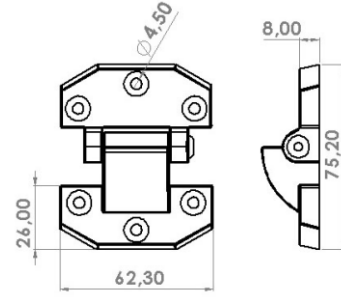
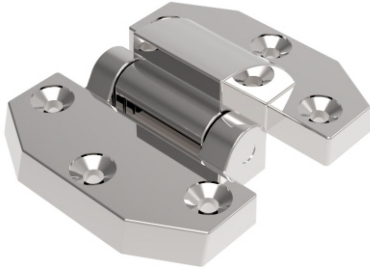

KURU HAVUZ MENTEŞE / DRY POOL HINGE

KODU / CODE	RENK / COLOR	MALZEME / MATERIAL	TİP / TYPE	AĞIRLIK / WEIGHT/GR	AD / PCS
ES-252-01	KRO/CHROMIUM	ZAMAK 5 / ZINCS	STANDART MODEL / STANDART MODEL	171	100

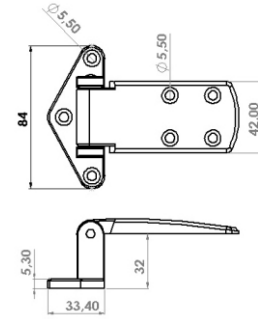

VİTRİN MENTEŞE BOMBELİ / SHOWCASE HINGE DOME

KODU / CODE	RENK / COLOR	MALZEME / MATERIAL	TİP / TYPE	AĞIRLIK / WEIGHT/GR	AD / PCS
ES-231-01	KROM/CHROMIUM	ZAMAK 5 / ZINCS	STANDART MODEL / STANDART MODEL	190	1

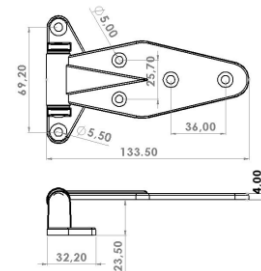
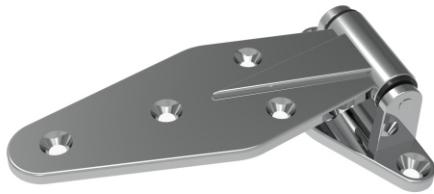

KARAMAN MENTEŞE / REFRIGERATOR LOCK

KODU / CODE	RENK / COLOR	MALZEME / MATERIAL	TİP / TYPE	AĞIRLIK / WEIGHT/GR	AD / PCS
ES-233-01	KROM/CHROMIUM	KROM	STANDART MODEL / STANDART MODEL	415.50	1

ENDÜSTRİYEL MUTFAK GRUBU / THE GROUPS OF INDUSTRIAL KITCHEN

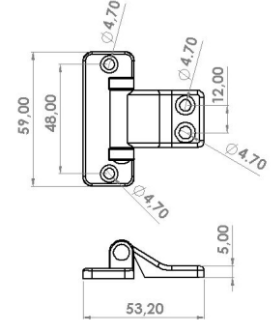

KISA HAVUZ MENTEŞE / SHORT POOL HINGE

KODU / CODE	RENK / COLOR	MALZEME / MATERIAL	TİP / TYPE	AĞIRLIK / WEIGHT/GR	AD / PCS
ES-234-02	KROM/CHROMIUM	ZAMAK	KISA MODEL / SHORT MODEL	72.50	50

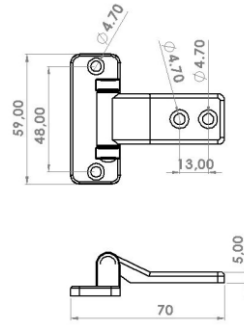

UZUN HAVUZ MENTEŞE / LONG POOL HINGE

KODU / CODE	RENK / COLOR	MALZEME / MATERIAL	TİP / TYPE	AĞIRLIK / WEIGHT/GR	AD / PCS
ES-234-01	KROM/CHROMIUM	ZAMAK 5 / ZINCS	UZUN MODEL / LONG MODEL	79.50	1

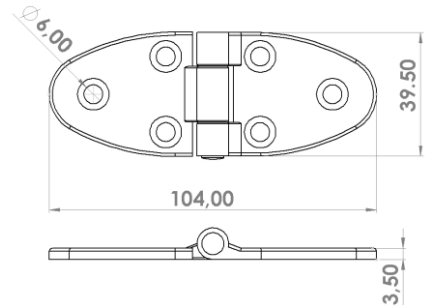

YAPRAK MENTEŞE / LEAF HINGE

KODU / CODE	RENK / COLOR	MALZEME / MATERIAL	TİP / TYPE	AĞIRLIK / WEIGHT/GR	AD / PCS
ES-232-01	KROM/CHROMIUM	ZAMAK 5 / ZINCS	UZUN MODEL / LONG MODEL	75	1

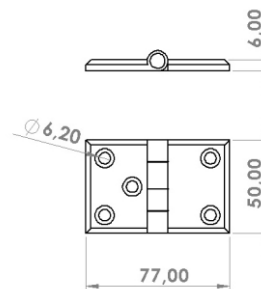
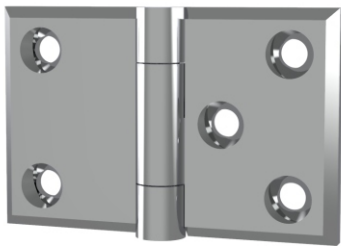

KARE YAPRAK MENTEŞE / SQUARE LEAF HINGE

KODU / CODE	RENK / COLOR	MALZEME / MATERIAL	TİP / TYPE	AĞIRLIK / WEIGHT/GR	AD / PCS
ES-238-01	KROM/CHROMIUM	KROM	UFAK MODEL	102	1

ENDÜSTRİYEL MUTFAK GRUBU / THE GROUPS OF INDUSTRIAL KITCHEN

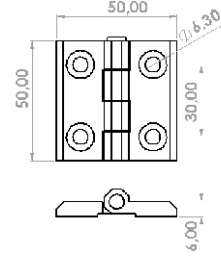
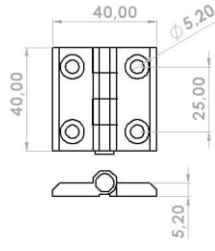
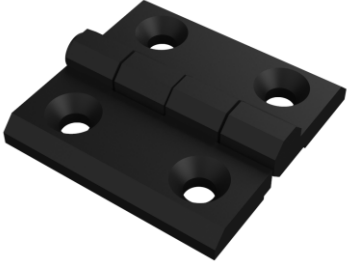

40X40 YAPRAK MENTEŞE PLASTİK / SQUARE HINGE PLASTIC

KODU / CODE	RENK / COLOR	MALZEME / MATERIAL	TİP / TYPE	AĞIRLIK / WEIGHT/GR	AD / PCS
ES-238-02	SİYAH /BLACK	PA 6	40X40	12.50	100
ES-238-03	SİYAH /BLACK	PA 6	50X50	15	100



PLASTİK CAM TUTUCU / PLASTIC GLASS HOLDER

KODU / CODE	RENK / COLOR	MALZEME / MATERIAL	TİP / TYPE	AĞIRLIK / WEIGHT/GR	AD / PCS
ES-239-03	GRİ /GRAY	PA 6	PLASTİK/PLASTIC	8	500

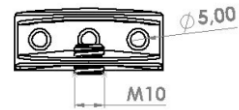
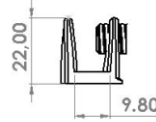
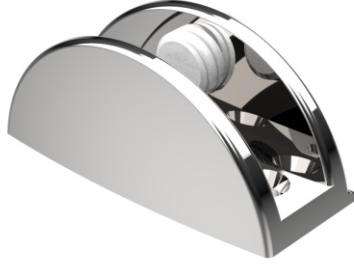

UZUN CAM TUTUCU / LONG GLASS HOLDER

KODU / CODE	RENK / COLOR	MALZEME / MATERIAL	TİP / TYPE	AĞIRLIK / WEIGHT/GR	AD / PCS
ES-239-01	KROM/CHROMIUM	ZAMAK	BÜYÜK TİP	36.50	1

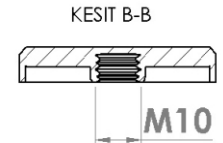
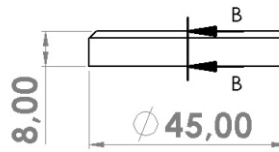
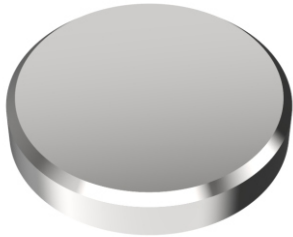

ZAMAK FLANŞ / ZINC COVER

KODU / CODE	RENK / COLOR	MALZEME / MATERIAL	TİP / TYPE	AĞIRLIK / WEIGHT/GR	AD / PCS
EC-239-03	KROM/CHROMIUM	ZAMAK	STANDART MODEL	82	50

ENDÜSTRİYEL MUTFAK GRUBU / THE GROUPS OF INDUSTRIAL KITCHEN



STİPİ SU GİDERİ / TYPE WATER DRAIN

KODU / CODE	RENK / COLOR	MALZEME / MATERIAL	TİP / TYPE	AĞIRLIK / WEIGHT/GR	AD / PCS
ES-209-SM	SİYAH/BLACK	PA6	S TİPİ / SYPE	81,50	1



PLASTİK KULP / PLASTIC HANDLE

KODU / CODE	RENK / COLOR	MALZEME / MATERIAL	TİP / TYPE	AĞIRLIK / WEIGHT/GR	AD / PCS
ES-265-01	SİYAH / BLACK	NY 6	120mm		50
ES-265-02	SİYAH / BLACK	NY 6	140mm		50



ÇÖP SİYIRMA LASTİĞİ / GARBAGE SCRAPING RUBBER

KODU / CODE	RENK / COLOR	MALZEME / MATERIAL	TİP / TYPE	AĞIRLIK / WEIGHT/GR	AD / PCS
ES-263-02	SİYAH / BLACK	LASTİK / RUBBER	STANDART		1

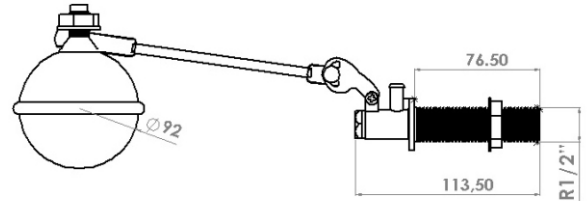

FLATÖR / FLAT

KODU / CODE	RENK / COLOR	MALZEME / MATERIAL	TİP / TYPE	AĞIRLIK / WEIGHT/GR	AD / PCS
ES-245-01	METALİK GRİ / METALLIC GRAY	PİRİNÇ / BRASS	STANDART MODEL	297.50	1

ENDÜSTRİYEL MUTFAK GRUBU / THE GROUPS OF INDUSTRIAL KITCHEN



mm	mm	mm	mm	mm	kg	kg
75	25	98	65x65	47x47	0,28	50

HAFİF TİP FREN SİZ DÖNER TEKER / LIGHT TYPE BRAKE FREE ROTARY WHEEL

KODU / CODE	RENK / COLOR	MALZEME / MATERIAL	TİP / TYPE	AĞIRLIK / WEIGHT/GR	AD / PCS
ES-246-01	SİYAH/BLACK	MOBLEN / POLYPROPYLENE	ÇAP 75-50KG		100



mm	mm	mm	mm	mm	kg	kg
75	25	98	65x65	47x47	0,345	50

HAFİF TİP FREN Lİ DÖNER TEKER / LIGHT TYPE BRAKE ROTARY WHEEL

KODU / CODE	RENK / COLOR	MALZEME / MATERIAL	TİP / TYPE	AĞIRLIK / WEIGHT/GR	AD / PCS
ES-246-02	SİYAH/BLACK	MOBLEN / POLYPROPYLENE	ÇAP 75-50KG		100



mm	mm	mm	mm	mm	kg	kg
55	25	84	87x66	65x46	0,42	150

AĞIR TİP FREN SİZ DÖNER TEKER / HEAVY TYPE WITHOUT BRAKE ROTARY WHEEL

KODU / CODE	RENK / COLOR	MALZEME / MATERIAL	TİP / TYPE	AĞIRLIK / WEIGHT/GR	AD / PCS
ES-247-01	BEYAZ / WHITE	MOBLEN / POLYPROPYLENE	ÇAP 55-130 KG		100



mm	mm	mm	mm	mm	kg	kg
55	25	84	87x66	65x46	0,455	150

AĞIR TİP FREN Lİ DÖNER TEKER / HEAVY TYPE BRAKE ROTARY WHEEL

KODU / CODE	RENK / COLOR	MALZEME / MATERIAL	TİP / TYPE	AĞIRLIK / WEIGHT/GR	AD / PCS
ES-247-02	BEYAZ/WHITE	MOBLEN / POLYPROPYLENE	ÇAP 55-130KG		100

SOĞUK ODA GRUBU/COLD ROOM ACCESORIES

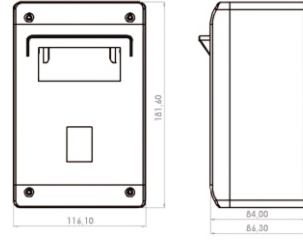

SOĞUK ODA PANO KUTUSU / COLD ROOM CONTROL BOXES

KODU / CODE	RENK / COLOR	MALZEME / MATERIAL	TİP / TYPE	AĞIRLIK / WEIGHT/GR	AD / PCS
ES-100-1G	BEYAZ/WHITE	ABS	1 GÖZ/ONE BUTTON	207	30

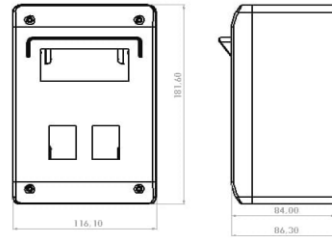

SOĞUK ODA PANO KUTUSU / COLD ROOM CONTROL BOXES

KODU / CODE	RENK / COLOR	MALZEME / MATERIAL	TİP / TYPE	AĞIRLIK / WEIGHT/GR	AD / PCS
ES-100-2G	BEYAZ/WHITE	ABS	2 GÖZ/TWO BUTTONS	205	30

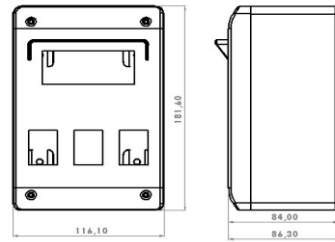

SOĞUK ODA PANO KUTUSU / COLD ROOM CONTROL BOXES

KODU / CODE	RENK / COLOR	MALZEME / MATERIAL	TİP / TYPE	AĞIRLIK / WEIGHT/GR	AD / PCS
ES-100-3G	BEYAZ/WHITE	ABS	3 GÖZ/THREE BUTTONS	203	30

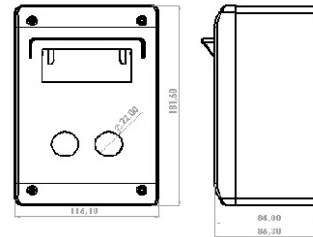

SOĞUK ODA PANO KUTUSU / COLD ROOM CONTROL BOXES

KODU / CODE	RENK / COLOR	MALZEME / MATERIAL	TİP / TYPE	AĞIRLIK / WEIGHT/GR	AD / PCS
ES-100-Y2	BEYAZ/WHITE	ABS	2 GÖZ/TWO BUTTONS	205	30

SOĞUK ODA GRUBU / COLD ROOM HARDWARE

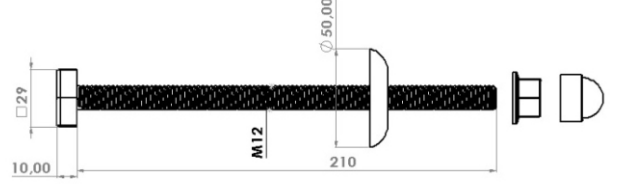
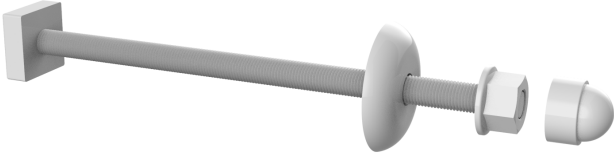

PANEL BAĞLANTI APARATI / PANEL ASSEMBLY APPARATUS

KODU / CODE	RENK / COLOR	MALZEME / MATERIAL	TİP / TYPE	AĞIRLIK / WEIGHT/GR	AD / PCS
ES -101-K50	BEYAZ / WHITE	P66	210MM SAPLAMA+ÇAP50 LİK FLANŞ / SCREW LENGHT 210MM FLANGE DIAMETER 50MM	56	100

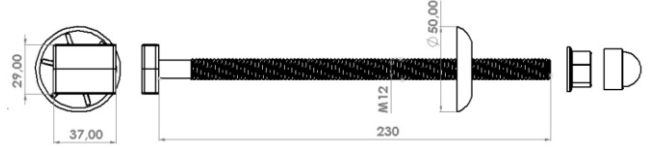

PANEL BAĞLANTI APARATI / PANEL ASSEMBLY APPARATUS

KODU / CODE	RENK / COLOR	MALZEME / MATERIAL	TİP / TYPE	AĞIRLIK / WEIGHT/GR	AD / PCS
ES -101-U50	BEYAZ / WHITE	P66	230MM SAPLAMA+ÇAP50 LİK FLANŞ / SCREW LENGHT 230MM FLANGE DIAMETER 50MM	62	100

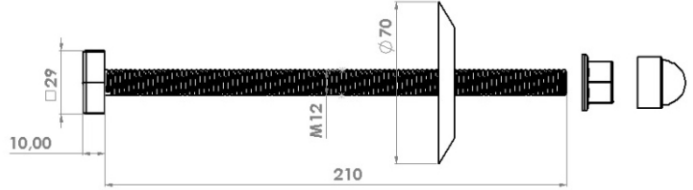
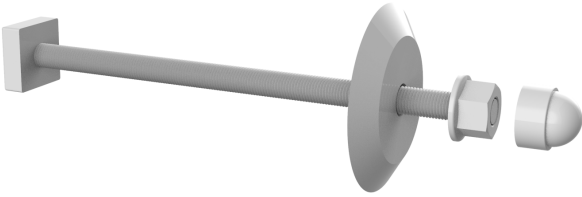

PANEL BAĞLANTI APARATI / PANEL ASSEMBLY APPARATUS

KODU / CODE	RENK / COLOR	MALZEME / MATERIAL	TİP / TYPE	AĞIRLIK / WEIGHT/GR	AD / PCS
ES -101-K70	BEYAZ / WITE	P66	210MM SAPLAMA+ÇAP70 LİK FLANŞ / SCREW LENGHT 210MM FLANGE DIAMETER 70MM	66	100

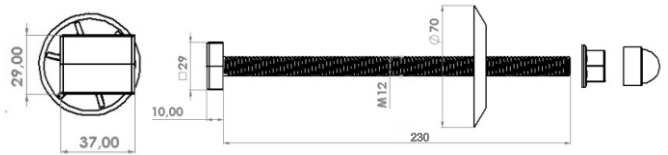
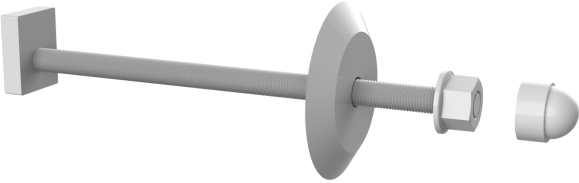

PANEL BAĞLANTI APARATI / PANEL ASSEMBLY APPARATUS

KODU / CODE	RENK / COLOR	MALZEME / MATERIAL	TİP / TYPE	AĞIRLIK / WEIGHT/GR	AD / PCS
ES -101-U70	BEYAZ / WHITE	P66	230MM SAPLAMA+ÇAP70 LİK FLANŞ / SCREW LENGHT 230MM FLANGE DIAMETER 70MM	72	100

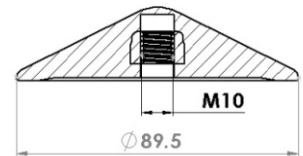
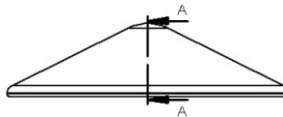

M10 PANEL TAVAN BAĞLANTI SOMUNU / PANEL ASSEMBLY SCREW

KODU / CODE	RENK / COLOR	MALZEME / MATERIAL	TİP / TYPE	AĞIRLIK / WEIGHT/GR	AD / PCS
ES-102	BEYAZ / WHITE	P66	ÇAP / DIAMETER 87.5	70.5	100

SOĞUK ODA GRUBU / COLD ROOM HARDWARE

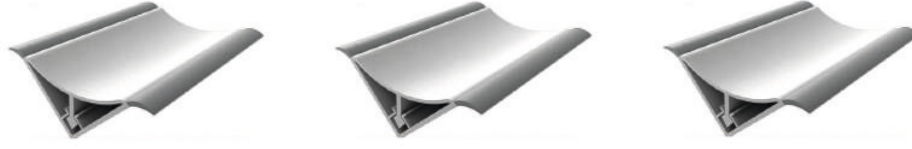

SOĞUK ODA HİJYEN PROFİLLERİ / HYGIENE CORNER CLOSING PROFILE

KODU / CODE	RENK / COLOR	MALZEME / MATERIAL	TİP / TYPE	AĞIRLIK / WEIGHT/GR	METRE
ES-103-50	BEYAZ / WHITE	PVC	50'LİK HİJYEN PROFİL / FOR 50MM HYGIENE PROFILE		150
ES-103-70	BEYAZ / WHITE	PVC	70'LİK HİJYEN PROFİL / FOR 70MM HYGIENE PROFILE		90
ES-103-100	BEYAZ / WHITE	PVC	100'LÜK HİJYEN PROFİL / FOR 100MM HYGIENE PROFILE		60

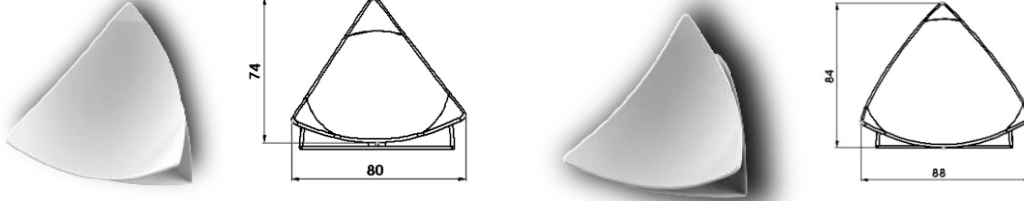

HİJYEN PROFİL KÖŞE KAPATMA APARATI / HYGIENE PROFILE CORNER CLOSING APPARATUS

KODU / CODE	RENK / COLOR	MALZEME / MATERIAL	TİP / TYPE	AĞIRLIK / WEIGHT/GR	AD / PCS
ES-104-70-02	BEYAZ / WHITE	PP	KÖŞE KAPATMA(70LİK) / STANDARD MODEL	11.5	100
ES-104-100-02	BEYAZ / WHITE	PP	KÖŞE KAPATMA(100 LÜK) / STANDARD MODEL	13.5	100



ZEMİN HİJYEN PROFİL / FLOOR HYGIENE CORNER CLOSING PROFILE

KODU / CODE	RENK / COLOR	MALZEME / MATERIAL	TİP / TYPE	AĞIRLIK / WEIGHT/GR	METRE
ES-105	BEYAZ / WHITE	PVC	ZEMİN PROFİL (100MM) / STANDARD MODEL		36



ZEMİN HİJYEN KÖŞE AKSESUARLARI / FLOOR HYGIENE CORNER CLOSING APPARATUS

KODU / CODE	RENK / COLOR	MALZEME / MATERIAL	TİP / TYPE	AĞIRLIK / WEIGHT/GR	AD / PCS
ES-106-01	BEYAZ / WHITE	PP	İÇ KÖŞE AKSESUARİ / FLOOR INSIDE CORNER CLOSING APPARATUS		10
ES-106-02	BEYAZ / WHITE	PP	DIŞ KÖŞE AKSESUARİ / FLOOR OUTSIDE CORNER CLOSING APPARATUS		10



ZEMİN HİJYEN KÖŞE KAPATMA APARATI / FLOOR HYGIENE CORNER CLOSING DEVICE

KODU / CODE	RENK / COLOR	MALZEME / MATERIAL	TİP / TYPE	AĞIRLIK / WEIGHT/GR	ADET
ES-106-03	BEYAZ/WHITE	PP	SAĞ KENAR KAPAĞI/ RIGHT SIDE COVER		10
ES-106-04	BEYAZ/WHITE	PP	SOL KENAR KAPAĞI/ LEFT SIDE COVER		10

SOĞUK ODA GRUBU / COOL ROOM HARDWARE

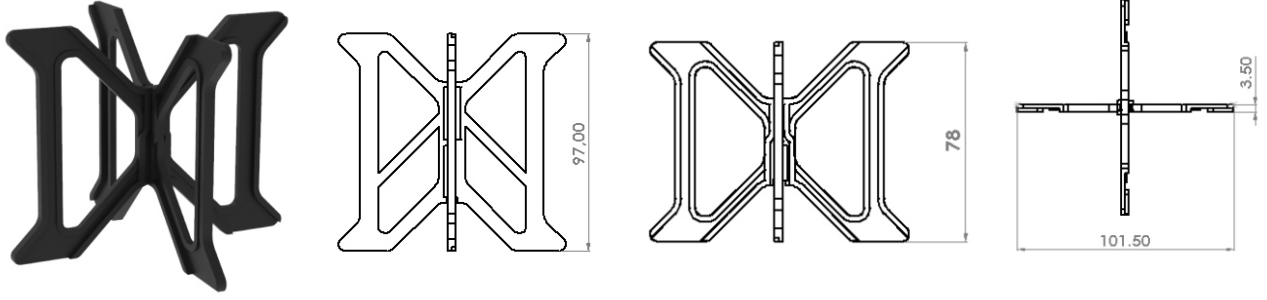

PANEL YÜKSELTME TAKOZU / PANEL UPGRADE PLASTIC WEDGE

KODU / CODE	RENK / COLOR	MALZEME / MATERIAL	TİP / TYPE	AĞIRLIK / WEIGHT/GR	AD / PCS
ES-107-01	SİYAH / BLACK	ABS	80'LİK TAKOZ / 80MM UPGRADE PLASTIC WEDGE	17	1000
ES-107-02	SİYAH / BLACK	ABS	100'LÜK TAKOZ / 100MM UPGRADE PLASTIC WEDGE	21.5	1000



SOĞUK ODA BASINÇ DENGELİ VALFİ / COLD ROOM PRES SURE BALANCE VALVE

KODU / CODE	RENK / COLOR	MALZEME / MATERIAL	TİP / TYPE	AĞIRLIK / WEIGHT/GR	AD / PCS
ES-110-02	BEYAZ/WHETE	ABS	75-150		1

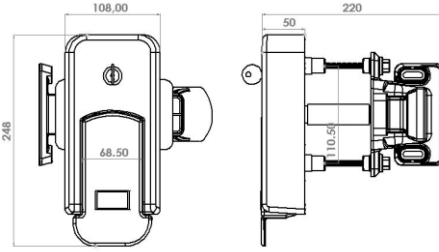

SOĞUK ODA KİLİDİ / COLD ROOM LOCK

KODU / CODE	RENK / COLOR	MALZEME / MATERIAL	TİP / TYPE	AĞIRLIK / WEIGHT/GR	AD / PCS
ES-108-01	GRI/GREY	NAYLON 66	STANDART		1

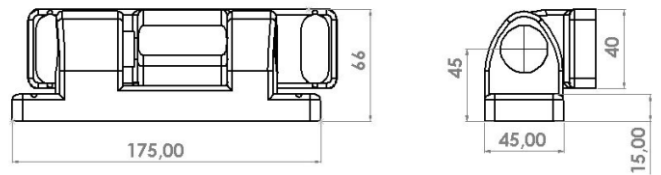
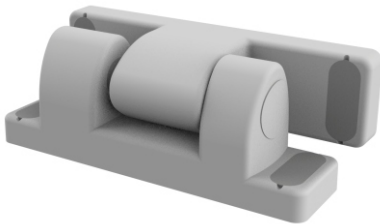

SOĞUK ODA KAPI MENTEŞE / COLD ROOM DOOR HINGE

KODU / CODE	RENK / COLOR	MALZEME / MATERIAL	TİP / TYPE	AĞIRLIK / WEIGHT/GR	AD / PCS
ES-109-01	GRI / GREY	PA 6	SATANDART	365	1

SOĞUK ODA GRUBU / COOL ROOM HARDWARE

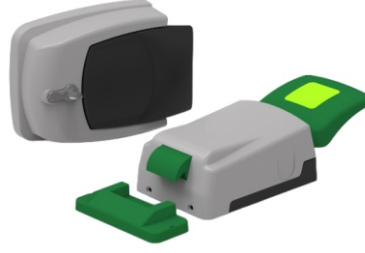

SOĞUK ODA KİLİDİ / COLD ROOM LOCK

KODU / CODE	RENK / COLOR	MALZEME / MATERIAL	TİP / TYPE	AĞIRLIK / WEIGHT/GR	AD / PCS
ES-117-01	GRİ / GRAY	PA66	STANDART/STANDARD		1

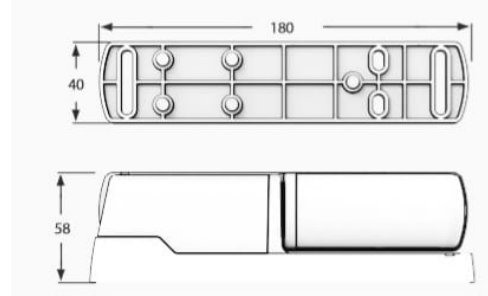

SOĞUK ODA MENTEŞE / COLD ROOM HINGE

KODU / CODE	RENK / COLOR	MALZEME / MATERIAL	TİP / TYPE	AĞIRLIK / WEIGHT/GR	AD / PCS
ES-117-02	GRİ / GRAY	PA66	180 mm KÜÇÜK MODEL / 180 mm SMALL TYPE		1
ES-117-03	GRİ / GRAY	PA66	212 mm BÜYÜK MODEL / 212 mm BIG TYPE		1



SOĞUK ODA KİLİDİ / COLD ROOM LOCK

KODU / CODE	RENK / COLOR	MALZEME / MATERIAL	TİP / TYPE	AĞIRLIK / WEIGHT/GR	AD / PCS
ES-120	GRİ/GREY	PA 66	STANDART/STANDARD		1



SOĞUK ODA KAPI MENTEŞE / COLD ROOM DOOR HINGE

KODU / CODE	RENK / COLOR	MALZEME / MATERIAL	TİP / TYPE	AĞIRLIK / WEIGHT/GR	AD / PCS
ES-119	GRİ / GREY	PA 66	SATANDART/STANDARD		1

SOĞUK ODA GRUBU/COLD ROOM ACCESORIES

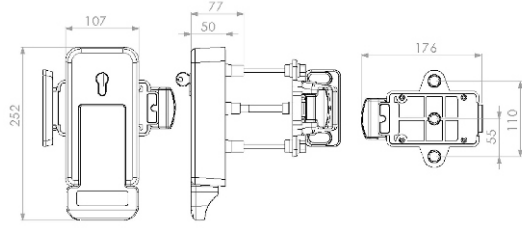
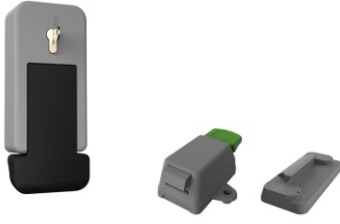

SOĞUK ODA KİLİDİ / COLD ROOM LOCK

KODU / CODE	RENK / COLOR	MALZEME / MATERIAL	TİP / TYPE	AĞIRLIK / WEIGHT/GR	AD / PCS
ES-125-1	GRİ/GRAY	PA 6	DİK DÖRTGEN/RECTANGLE		10

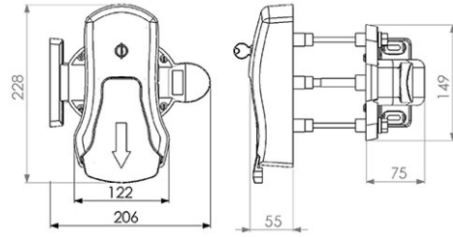

SOĞUK ODA KİLİDİ / COLD ROOM LOCK

KODU / CODE	RENK / COLOR	MALZEME / MATERIAL	TİP / TYPE	AĞIRLIK / WEIGHT/GR	AD / PCS
ES-125-2	GRİ/GRAY	PA 6	OVAL		10

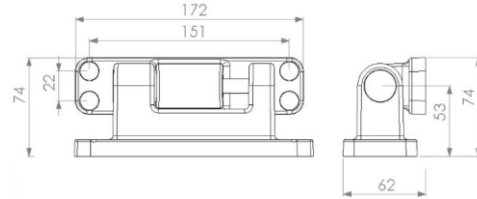
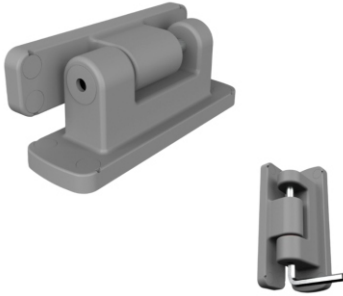

SOĞUK ODA KAPI MENTEŞESİ / COLD ROOM HINGE

KODU / CODE	RENK / COLOR	MALZEME / MATERIAL	TİP / TYPE	AĞIRLIK / WEIGHT/GR	AD / PCS
ES-125-3	GRİ/GRAY	PA 6	AYARLANA BİLİR/ADJUSTABLE		10

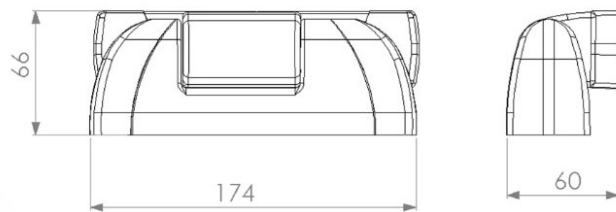
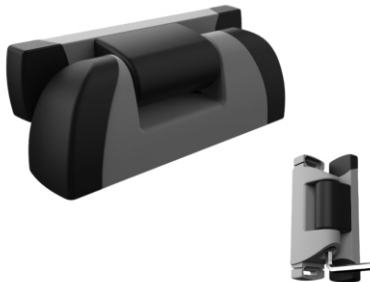

SOĞUK ODA KAPI MENTEŞESİ / COLD ROOM HINGE

KODU / CODE	RENK / COLOR	MALZEME / MATERIAL	TİP / TYPE	AĞIRLIK / WEIGHT/GR	AD / PCS
ES-125-4	GRİ/GRAY	PA 6	AYARLANA BİLİR/ADJUSTABLE		10

SOĞUK ODA GRUBU/COLD ROOM ACCESORIES

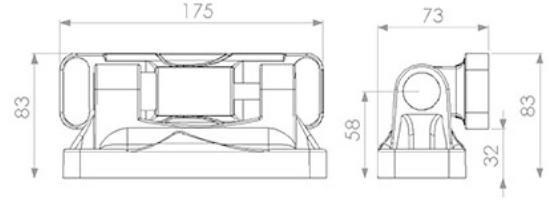
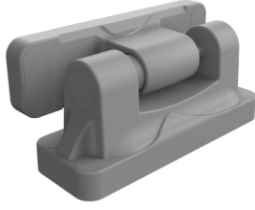

SOĞUK ODA KAPI MENTEŞESİ / COLD ROOM HINGE

KODU / CODE	RENK / COLOR	MALZEME / MATERIAL	TİP / TYPE	AĞIRLIK / WEIGHT/GR	AD / PCS
ES-125-5	GRİ/GRAY	PA 6	AYARSIZ/NON-ADJUSTABLE		10

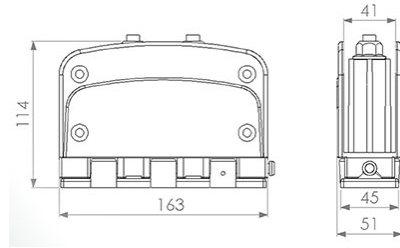

SOĞUK ODA SERVİS KAPI MENTEŞESİ / COLD ROOM SWING DOOR HINGE

KODU / CODE	RENK / COLOR	MALZEME / MATERIAL	TİP / TYPE	AĞIRLIK / WEIGHT/GR	AD / PCS
ES-125-6	GRİ/GRAY	PA 6	STANDART		10

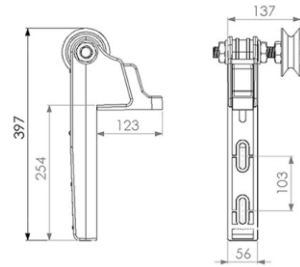

ASKI KOLU TEKER GRUBU / PLACTIC PULLEY WITHE PA WHEEL GROUPS

KODU / CODE	RENK / COLOR	MALZEME / MATERIAL	TİP / TYPE	AĞIRLIK / WEIGHT/GR	AD / PCS
ES-125-7	SİYAH/BLACK	PA 6	STANDART		10

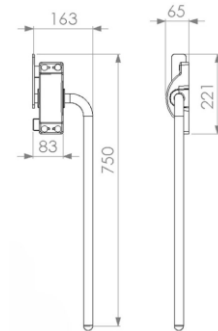

DIŞ AÇMA KOLU / EXTERNAL HANDLE

KODU / CODE	RENK / COLOR	MALZEME / MATERIAL	TİP / TYPE	AĞIRLIK / WEIGHT/GR	AD / PCS
ES-125-8	SİYAH/BLACK	PA 6	STANDART		10

SOĞUK ODA GRUBU/COLD ROOM ACCESORIES

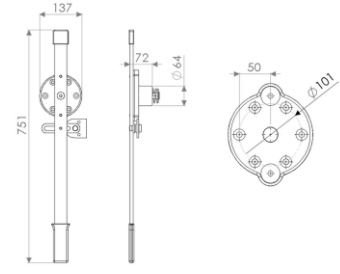

DIŞ AÇMA KOLU / EXTERNAL HANDLE

KODU / CODE	RENK / COLOR	MALZEME / MATERIAL	TİP / TYPE	AĞIRLIK / WEIGHT/GR	AD / PCS
ES-125-9	METALİK/METALİC	ALÜMİNYUM/ALUMINUM	STANDART		10

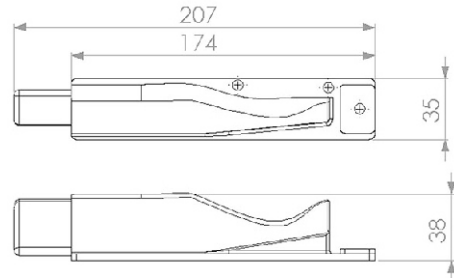

RAY YÖNLENDİRİCİ SOL / RAIL BEND GROOVE LEFT

KODU / CODE	RENK / COLOR	MALZEME / MATERIAL	TİP / TYPE	AĞIRLIK / WEIGHT/GR	AD / PCS
ES-126-1	SİYAH/BLACK	NY6	STANDART		10

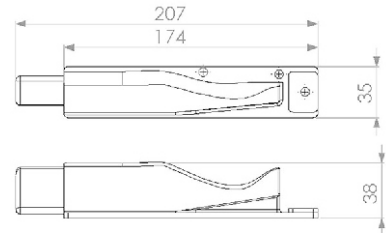

RAY YÖNLENDİRİCİ SAĞ / RAIL BEND GROOVE RIGHT

KODU / CODE	RENK / COLOR	MALZEME / MATERIAL	TİP / TYPE	AĞIRLIK / WEIGHT/GR	AD / PCS
ES-126-2	SİYAH/BLACK	NY6	STANDART		10

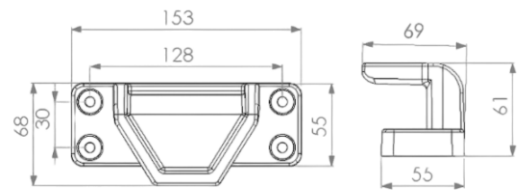

KASA ALT STOPLAMA / LOWER CLOSING HOOK FRAME PART

KODU / CODE	RENK / COLOR	MALZEME / MATERIAL	TİP / TYPE	AĞIRLIK / WEIGHT/GR	AD / PCS
ES-126-3	SİYAH/BLACK	NY6	STANDART		10

SOĞUK ODA GRUBU/COLD ROOM ACCESORIES

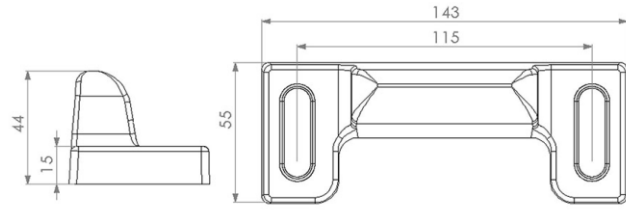

KANAT ALT STOPLAMA / LOWER GLOSING HOOK LEAF PART

KODU / CODE	RENK / COLOR	MALZEME / MATERIAL	TİP / TYPE	AĞIRLIK / WEIGHT/GR	AD / PCS
ES-126-4	SİYAH/BLACK	PA 6	STANDART		10

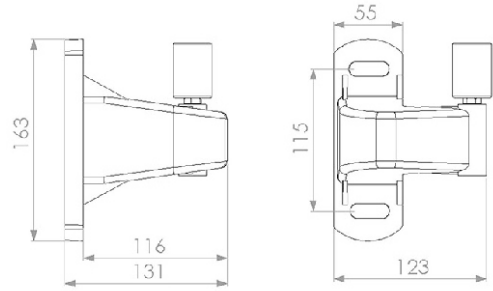

KUYRUK MAKARASI(SAĞ -SOL UYUMLU) / PLASTIC REAR REGISTER (LEFT AND RIGHT)

KODU / CODE	RENK / COLOR	MALZEME / MATERIAL	TİP / TYPE	AĞIRLIK / WEIGHT/GR	AD / PCS
ES-126-5	SİYAH/BLACK	PA 6	STANDART		10

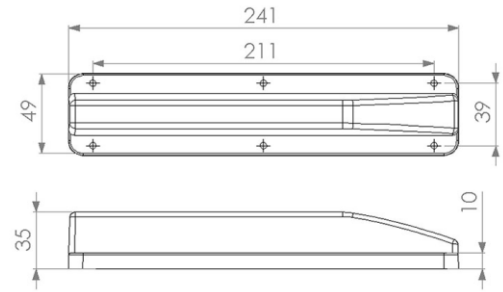

DENGELEME İÇ KOL ATLATMA / INTERNAL HANDLE BALANCER

KODU / CODE	RENK / COLOR	MALZEME / MATERIAL	TİP / TYPE	AĞIRLIK / WEIGHT/GR	AD / PCS
ES-126-6	YEŞİL/GREEN	PA 6	STANDART		10

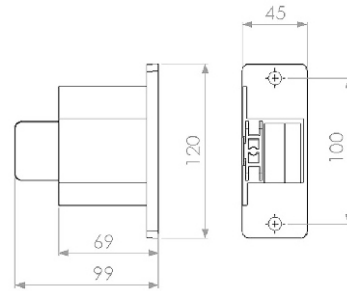
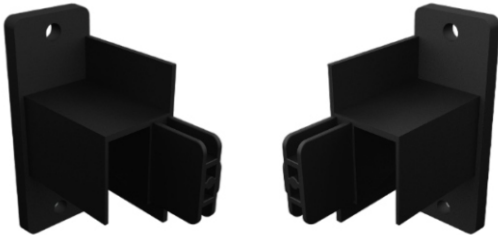

YAN RAY ÇATALI / SIDE RAIL GUIDE FIXING BRACKET RING

KODU / CODE	RENK / COLOR	MALZEME / MATERIAL	TİP / TYPE	AĞIRLIK / WEIGHT/GR	AD / PCS
ES-126-7L	SİYAH/BLACK	PA 6	SOL/LEFT		10
ES-126-7R	SİYAH/BLACK	PA 6	SAĞ/RIGHT		10

SOĞUK ODA GRUBU/COLD ROOM ACCESORIES

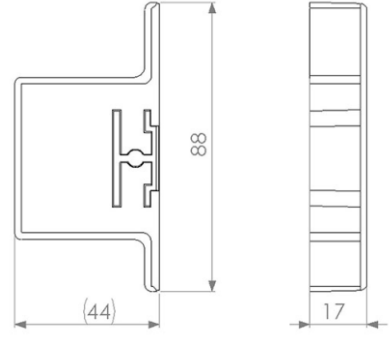
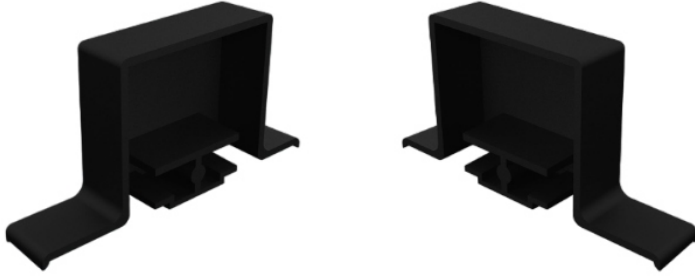

YAN RAY KAPAĞI / SIDE RAIL GUIDE COVER

KODU / CODE	RENK / COLOR	MALZEME / MATERIAL	TİP / TYPE	AĞIRLIK / WEIGHT/GR	AD / PCS
ES-126-8L	SİYAH/BLACK	PA 6	SOL/LEFT		10
ES-126-8R	SİYAH/BLACK	PA 6	SAĞ/RIGHT		10

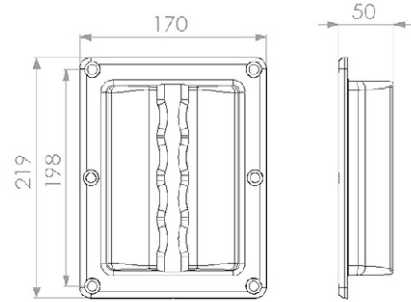

SÜRGÜLÜ KAPI İÇ KOLU / SLIDING DOOR INTERIOR HANDLE

KODU / CODE	RENK / COLOR	MALZEME / MATERIAL	TİP / TYPE	AĞIRLIK / WEIGHT/GR	AD / PCS
ES-110-02	SİYAH/BLACK	PA 6	DİKDÖRTGEN/RECTANGLE		10

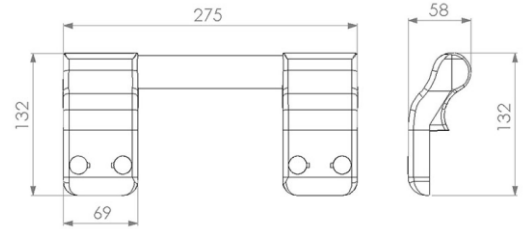

SÜRGÜLÜ KAPI DIŞAÇMA YARDIMCI KOL / SLIDING DOOR EXTERIOR OPENING AUXILIARY HANDLE

KODU / CODE	RENK / COLOR	MALZEME / MATERIAL	TİP / TYPE	AĞIRLIK / WEIGHT/GR	AD / PCS
ES-110-03	SİYAH/BLACK	PA 6	DİKDÖRTGEN/RECTANGLE		10

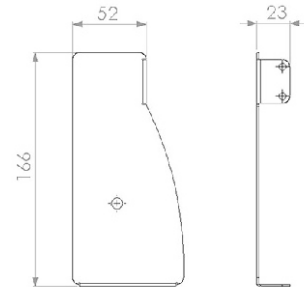

PASLANMAZ RAY KAPAK / STANLEES STEEL RAIL COVER

KODU / CODE	RENK / COLOR	MALZEME / MATERIAL	TİP / TYPE	AĞIRLIK / WEIGHT/GR	AD / PCS
ES-126-4L	METALİK/METALIC	PASLANMAZ ÇELİK/STANLEES STEEL	SOL/LEFT		10
ES-126-4R	METALİK/METALIC	PASLANMAZ ÇELİK/STANLEES STEEL	SAĞ/RIGHT		10

SOĞUK ODA GRUBU/COLD ROOM ACCESORIES

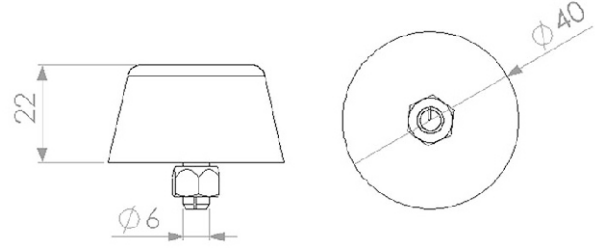

RAY STOP CONTASI / RAIL STOPPER RUBBER

KODU / CODE	RENK / COLOR	MALZEME / MATERIAL	TİP / TYPE	AĞIRLIK / WEIGHT/GR	AD / PCS
ES-110-05	SİYAH/BLACK	LASTİK/RUBBER	STANDART		10

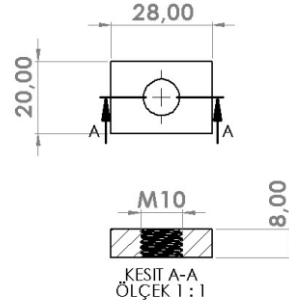
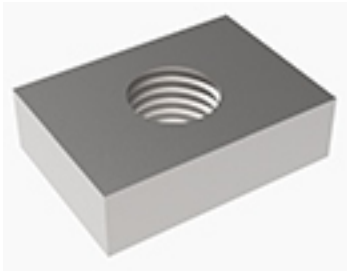

M10 TEKLİ KARE SOMUN / M10 SINGLE SQUARE NUT

KODU / CODE	RENK / COLOR	MALZEME / MATERIAL	TİP / TYPE	AĞIRLIK / WEIGHT/GR	AD / PCS
ES-113-08	METALİK/METALIC	DEMİR/IRON	TEK DELİK/ONE HOLE	30GR	100

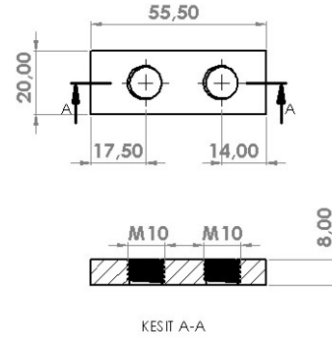

M10 ÇİFTLİ KARE SOMUN / M10 DOUBLE SQUARE NUT

KODU / CODE	RENK / COLOR	MALZEME / MATERIAL	TİP / TYPE	AĞIRLIK / WEIGHT/GR	AD / PCS
ES-113-09	METALİK/METALIC	DEMİR/IRON	İKİ DELİKLİ/TWO HOLE	59,50GR	100



M10 TİJ / M10 TİJ

KODU / CODE	RENK / COLOR	MALZEME / MATERIAL	TİP / TYPE	AĞIRLIK / WEIGHT/GR	AD / PCS
ES-115-01	METALİK/METALIC	DEMİR/IRON	1M		10

SOĞUK ODA GRUBU / COLD ROOM ACCESORIES

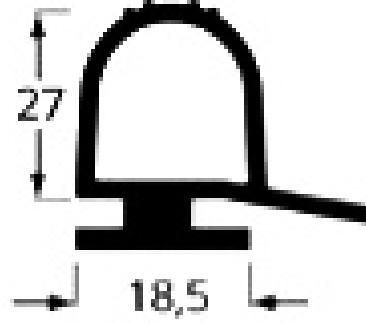

EPDM KAUÇUK CONTA / EPDM RUBBER SEAL

KODU / CODE	RENK / COLOR	MALZEME / MATERIAL	TİP / TYPE	AĞIRLIK / WEIGHT/GR	AD / PCS
ES-248-01	SİYAH/BLACK	EPDM KAUÇUK / EPDM RUBBER	STANDART		1



EPDM KAUÇUK CONTA / EPDM RUBBER SEAL

KODU / CODE	RENK / COLOR	MALZEME / MATERIAL	TİP / TYPE	AĞIRLIK / WEIGHT/GR	AD / PCS
ES-248-02	SİYAH/BLACK	EPDM KAUÇUK / EPDM RUBBER	STANDART		1

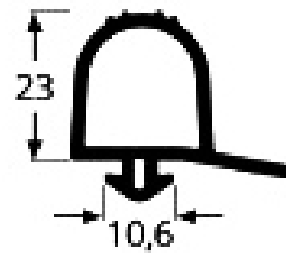

EPDM KAUÇUK CONTA / EPDM RUBBER SEAL

KODU / CODE	RENK / COLOR	MALZEME / MATERIAL	TİP / TYPE	AĞIRLIK / WEIGHT/GR	AD / PCS
ES-248-03	SİYAH/BLACK	EPDM KAUÇUK / EPDM RUBBER	STANDART		1

SOĞUK ODA GRUBU/COLD ROOM ACCESORIES

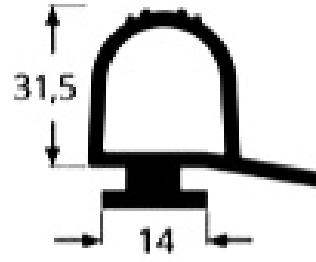

EPDM KAUÇUK CONTA / EPDM RUBBER SEAL

KODU / CODE	RENK / COLOR	MALZEME / MATERIAL	TİP / TYPE	AĞIRLIK / WEIGHT/GR	AD / PCS
ES-248-04	SİYAH/BLACK	EPDM KAUÇUK / EPDM RUBBER	STANDART		1

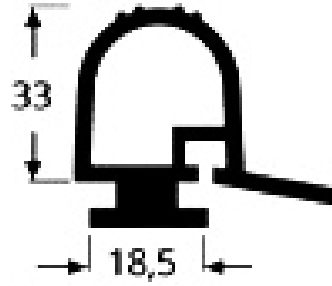
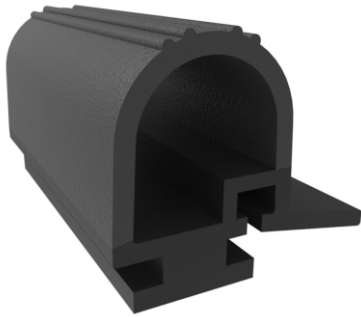

EPDM KAUÇUK CONTA / EPDM RUBBER SEAL

KODU / CODE	RENK / COLOR	MALZEME / MATERIAL	TİP / TYPE	AĞIRLIK / WEIGHT/GR	AD / PCS
ES-248-05	SİYAH/BLACK	EPDM KAUÇUK / EPDM RUBBER	STANDART		1

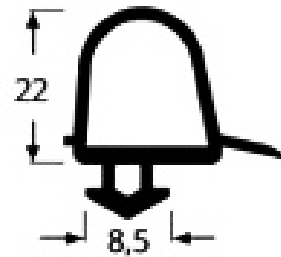

EPDM KAUÇUK CONTA / EPDM RUBBER SEAL

KODU / CODE	RENK / COLOR	MALZEME / MATERIAL	TİP / TYPE	AĞIRLIK / WEIGHT/GR	AD / PCS
ES-248-06	SİYAH/BLACK	EPDM KAUÇUK / EPDM RUBBER	STANDART		1

SOĞUK ODA GRUBU/COLD ROOM ACESORIES

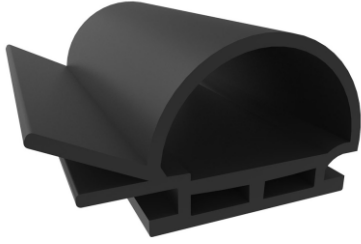

PVC CONTA / PVC GASKET

KODU / CODE	RENK / COLOR	MALZEME / MATERIAL	TİP / TYPE	AĞIRLIK / WEIGHT/GR	AD / PCS
ES-249-01	SİYAH/BLACK	PVC / PVC	STANDART		1

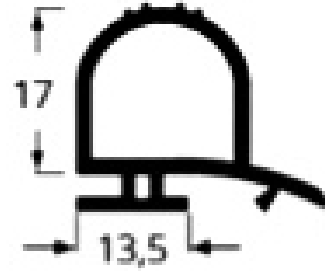

PVC CONTA / PVC GASKET

KODU / CODE	RENK / COLOR	MALZEME / MATERIAL	TİP / TYPE	AĞIRLIK / WEIGHT/GR	AD / PCS
ES-249-02	SİYAH/BLACK	PVC / PVC	STANDART		1

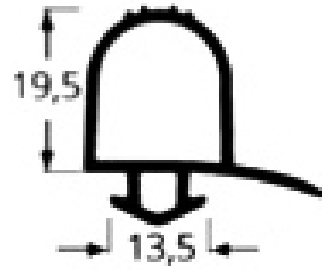

PVC CONTA / PVC GASKET

KODU / CODE	RENK / COLOR	MALZEME / MATERIAL	TİP / TYPE	AĞIRLIK / WEIGHT/GR	AD / PCS
ES-249-03	SİYAH/BLACK	PVC / PVC	STANDART		1

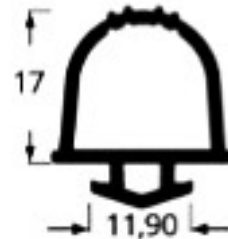

PVC CONTA / PVC GASKET

KODU / CODE	RENK / COLOR	MALZEME / MATERIAL	TİP / TYPE	AĞIRLIK / WEIGHT/GR	AD / PCS
ES-249-04	SİYAH/BLACK	PVC / PVC	STANDART		1

SOĞUK ODA GRUBU / COLD ROOM ACCESORIES

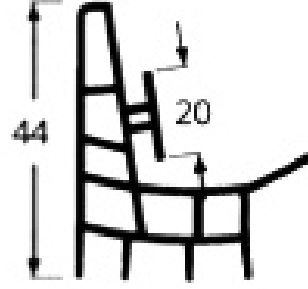
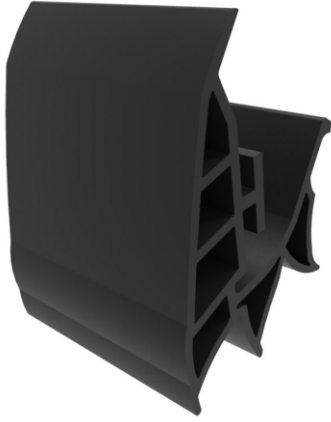

PVCTABAN CONTA / PVC BASE GASKET

KODU / CODE	RENK / COLOR	MALZEME / MATERIAL	TİP / TYPE	AĞIRLIK / WEIGHT/GR	AD / PCS
ES-250-01	SİYAH/BLACK	PVC	STANDART		1

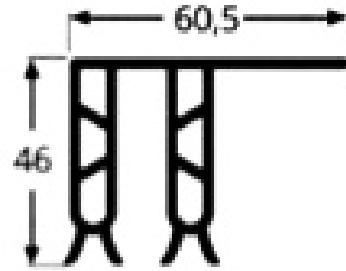
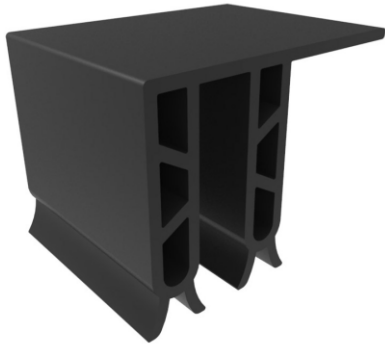

KODU / CODE	RENK / COLOR	MALZEME / MATERIAL	TİP / TYPE	AĞIRLIK / WEIGHT/GR	AD / PCS
ES-250-02	SİYAH/BLACK	PVC	STANDART		1

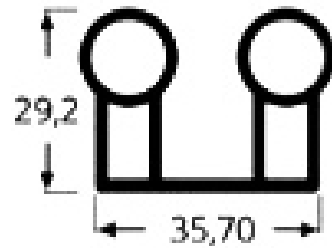
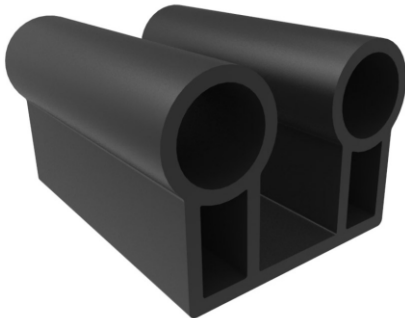

PVCTABAN CONTA / PVC BASE GASKET

KODU / CODE	RENK / COLOR	MALZEME / MATERIAL	TİP / TYPE	AĞIRLIK / WEIGHT/GR	AD / PCS
ES-250-03	SİYAH/BLACK	PVC	STANDART		1

SOĞUK ODA GRUBU/COLD ROOM ACCESORIES

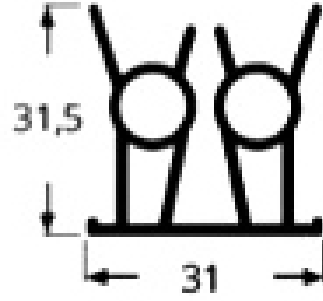
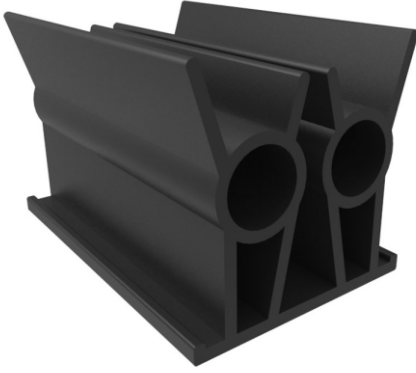

PVC TABAN CONTA / PVC BASE GASKET

KODU / CODE	RENK / COLOR	MALZEME / MATERIAL	TİP / TYPE	AĞIRLIK / WEIGHT/GR	AD / PCS
ES-250-04	SİYAH/BLACK	PVC	STANDART		1

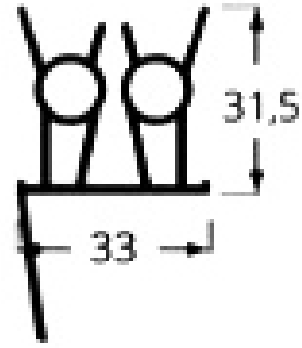

PVC TABAN CONTA / PVC BASE GASKET

KODU / CODE	RENK / COLOR	MALZEME / MATERIAL	TİP / TYPE	AĞIRLIK / WEIGHT/GR	AD / PCS
ES-250-05	SİYAH/BLACK	PVC	STANDART		1

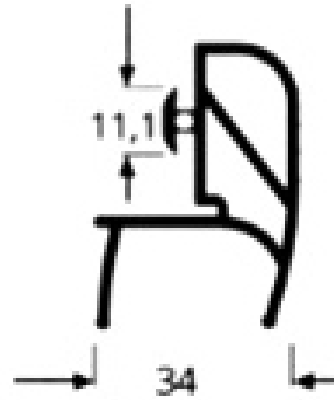

PVC TABAN CONTA / PVC BASE GASKET

KODU / CODE	RENK / COLOR	MALZEME / MATERIAL	TİP / TYPE	AĞIRLIK / WEIGHT/GR	AD / PCS
ES-250-06	SİYAH/BLACK	PVC	STANDART		1



NORTHCOOLING

Vatan Mah.Sinanpaşa Sk.Genç Sanayi Sitesi No:1/C Bayrampaşa / İSTANBUL

Tel: 0541 760 70 17 www.northcooling.com.tr